

总面积: 38246.01亩

名称: 武汉化学工业区

指北针



图例

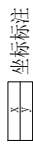

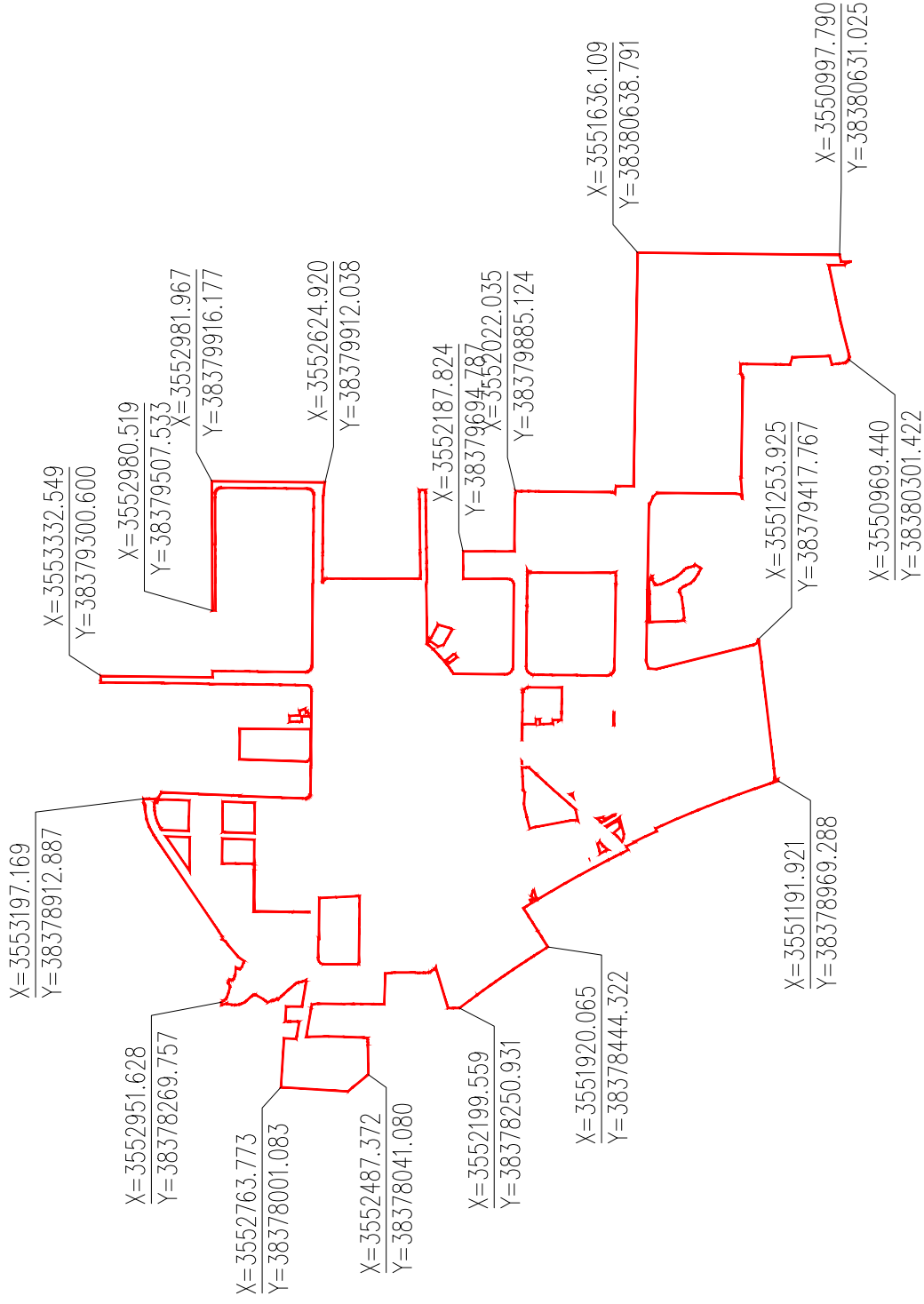

总面积: 3033.81亩

名称: 枣阳市化工工业园区

指北针



图例

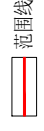

范围线

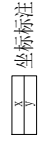

坐标标注

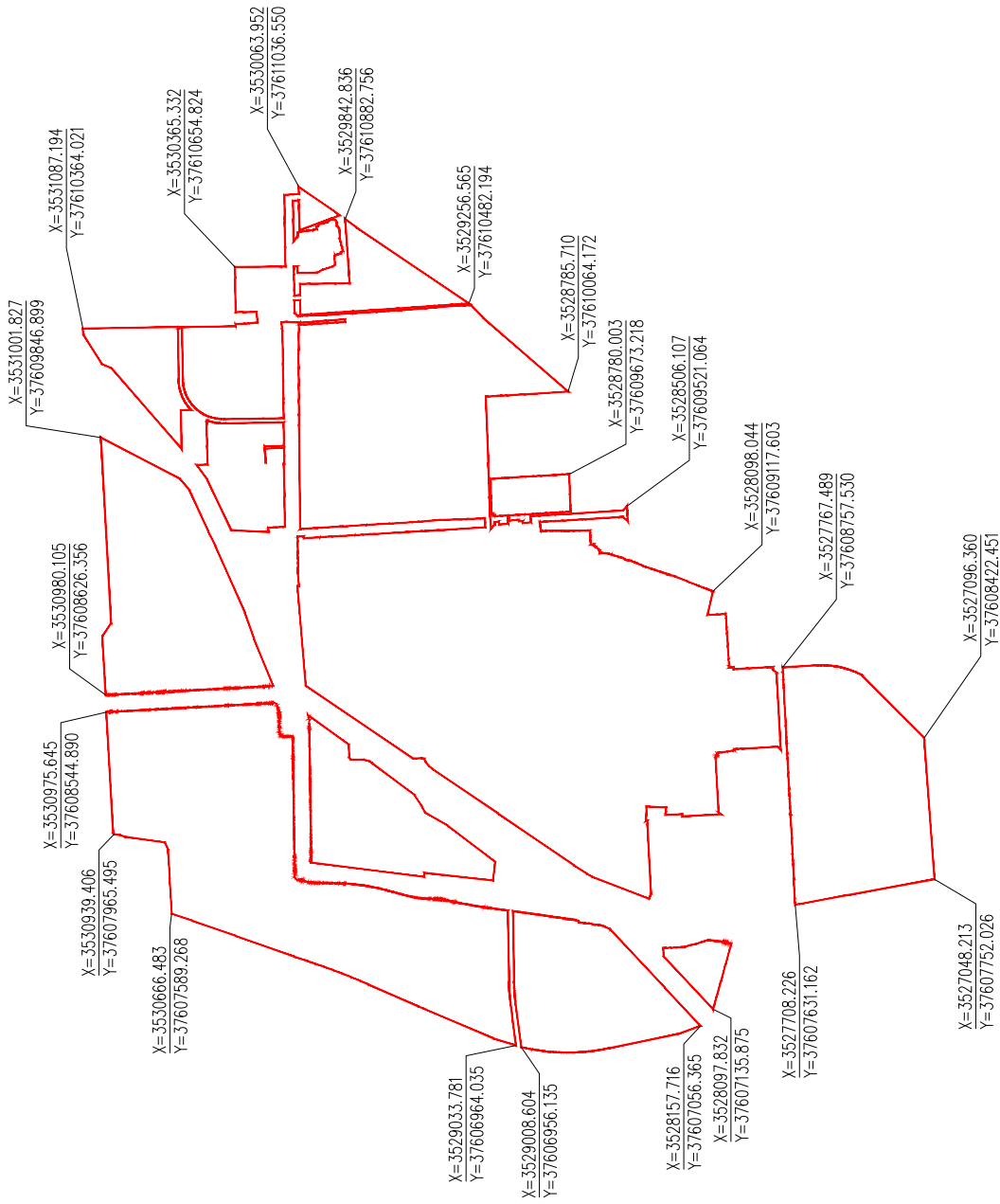

总面积: 11699.16亩

名称: 襄城经济开发区余家湖化工园

指北针



图例



范围线

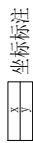

坐标标注

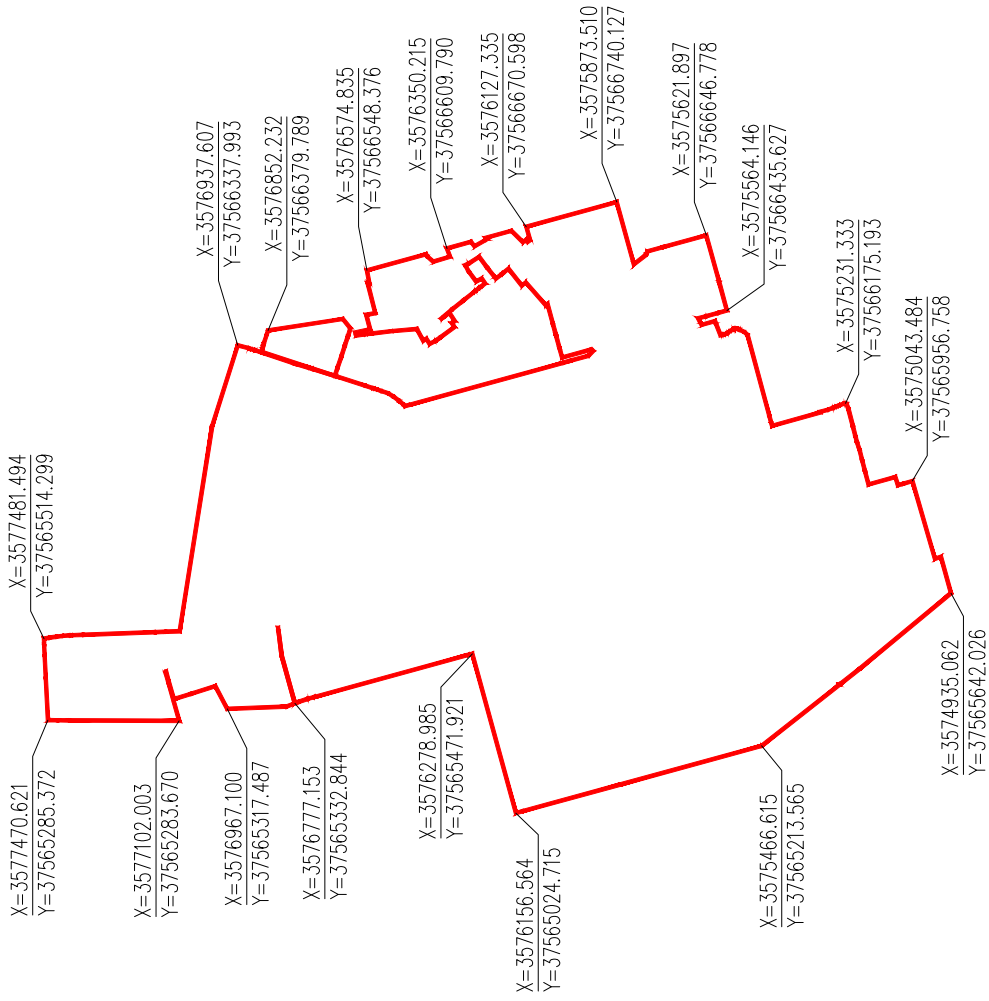
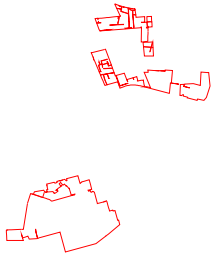

总面积: 5442.67亩

名称: 老河口市化工园区

指北针



图例

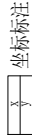

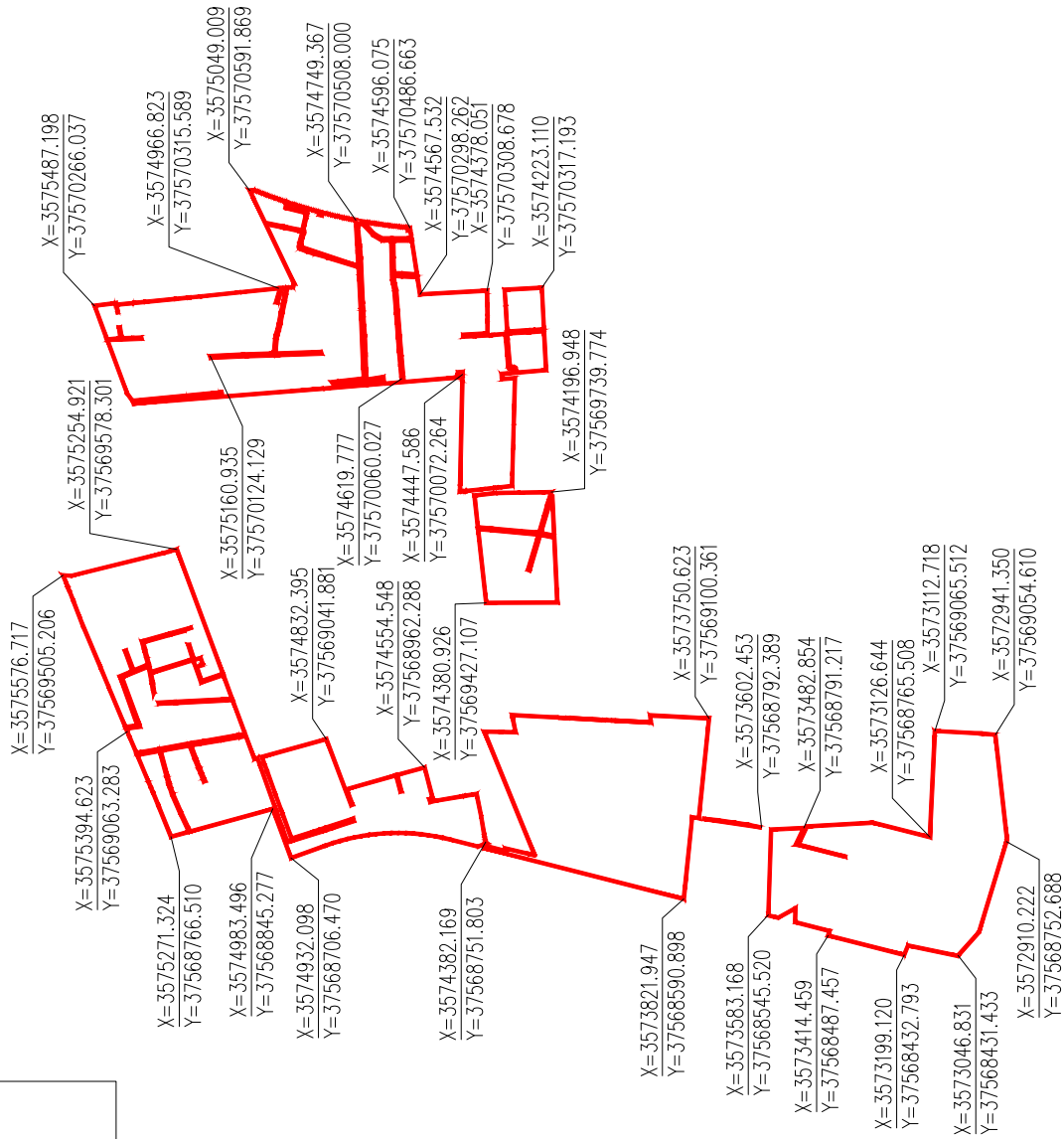
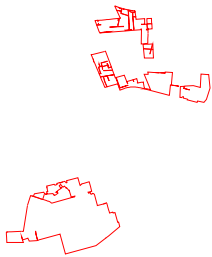

总面积: 5442.67亩

名称: 老河口市化工园区

指北针



图例



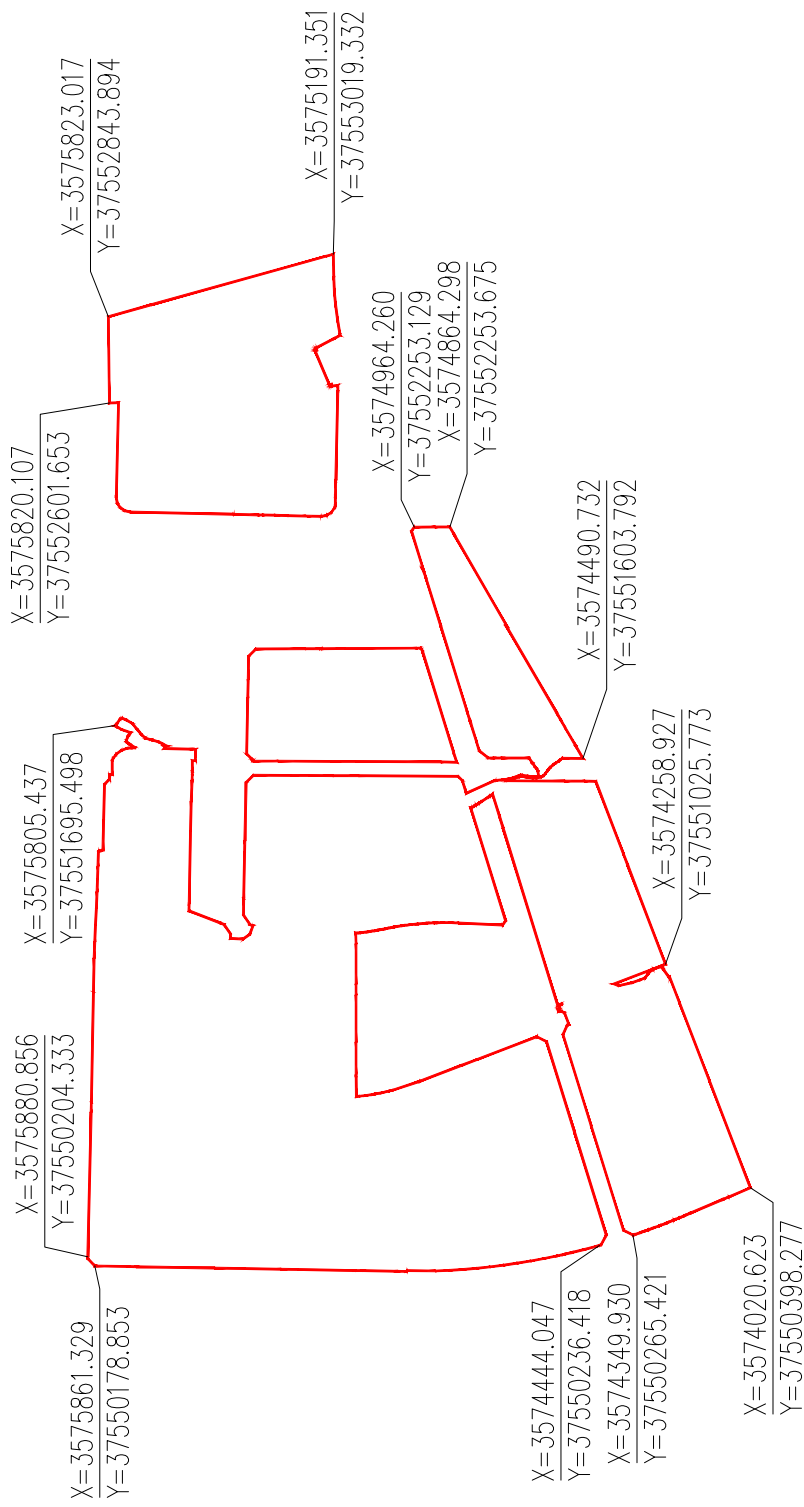

名称：谷城化工园区	指北针		图例	范围线	坐标标注	总面积：3896.32亩
-----------	-----	--	----	-----	------	--------------

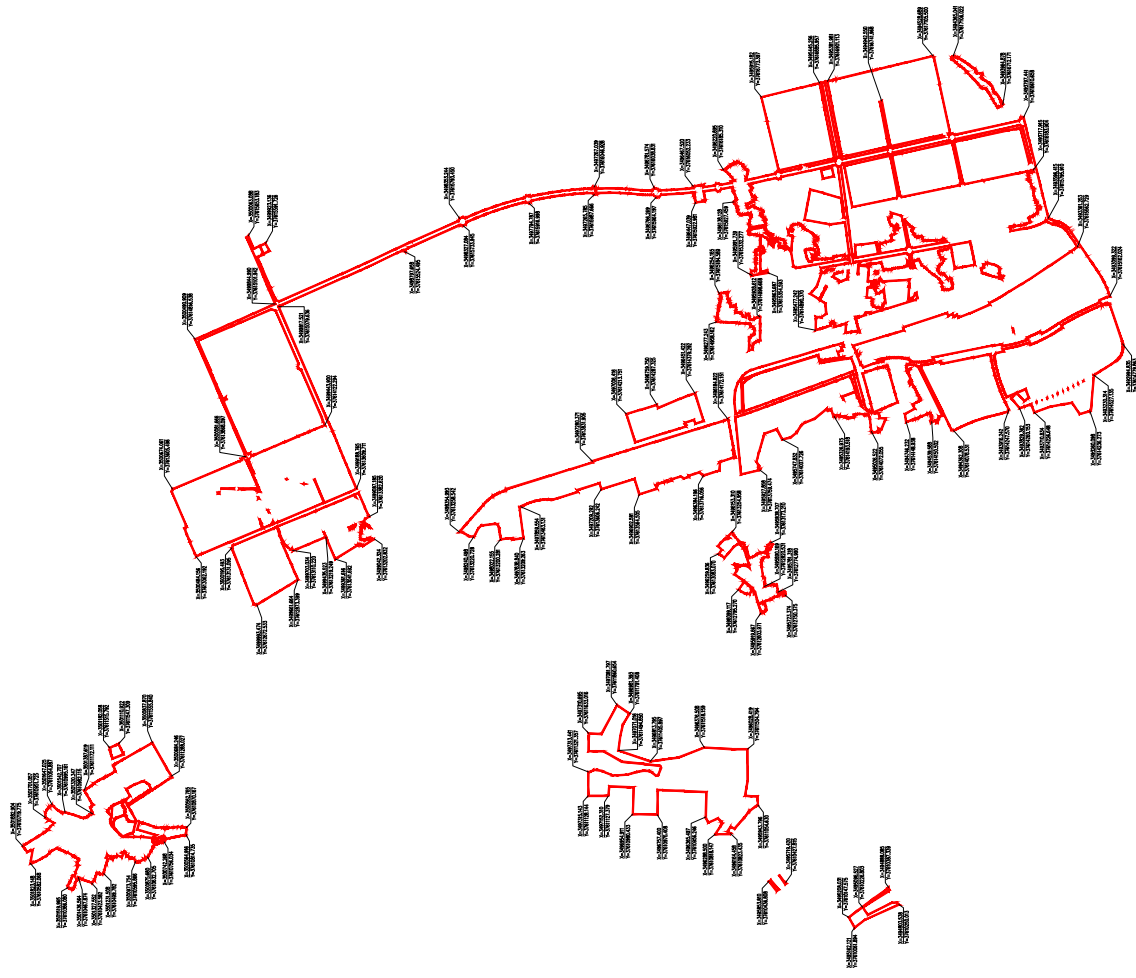

总面积: 11786.00亩

名称: 襄阳 (宜城) 精细化工产业园

指北针



图例

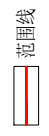

范围线



坐标标注

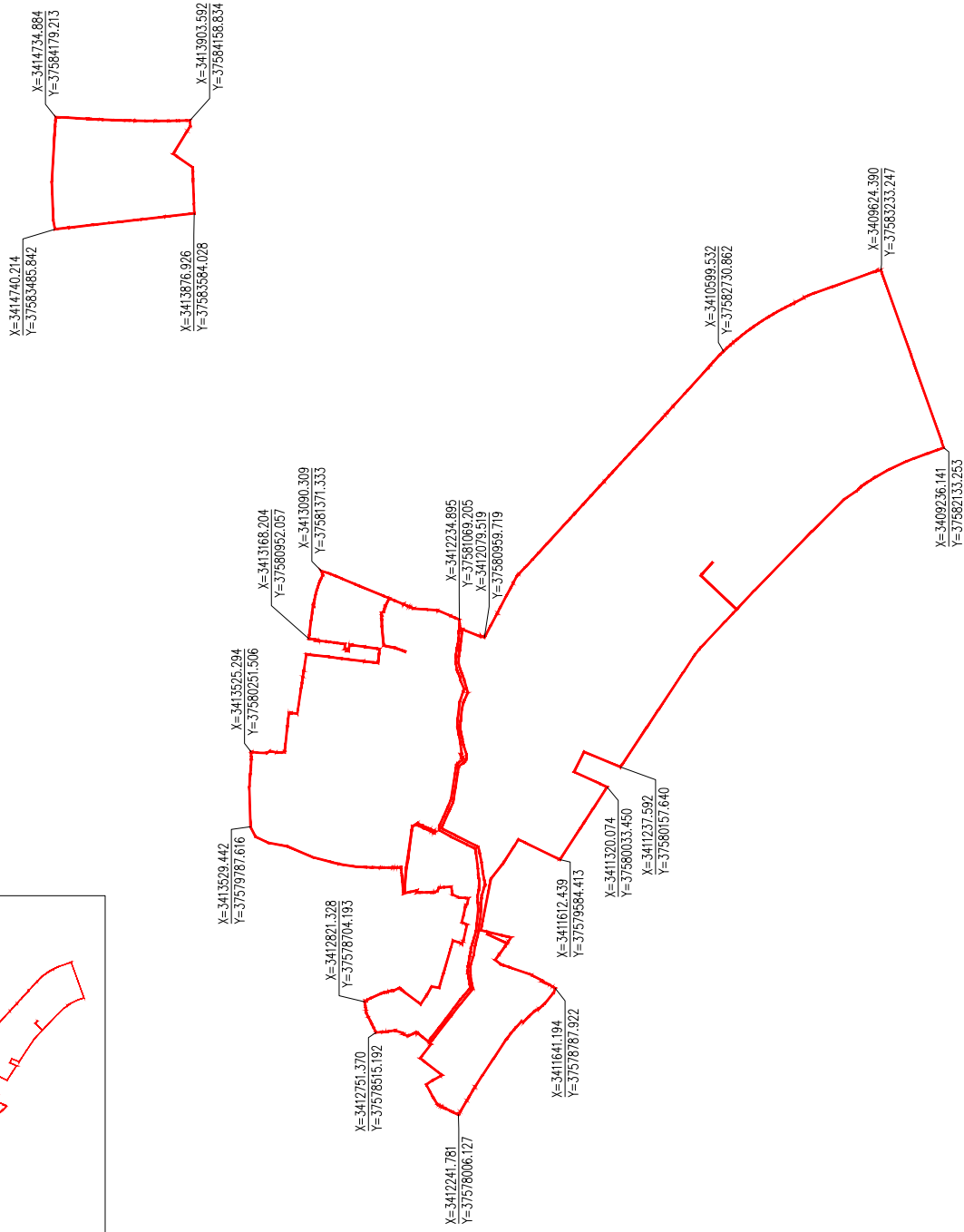
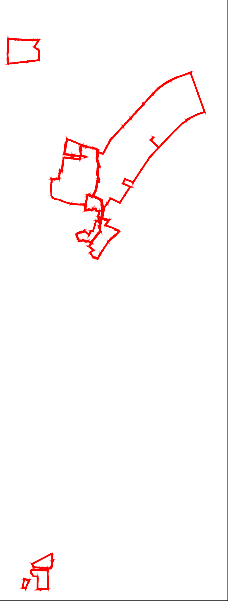

总面积: 11732.84亩

名称: 当阳坝陵化工园

指北针



图例

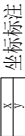

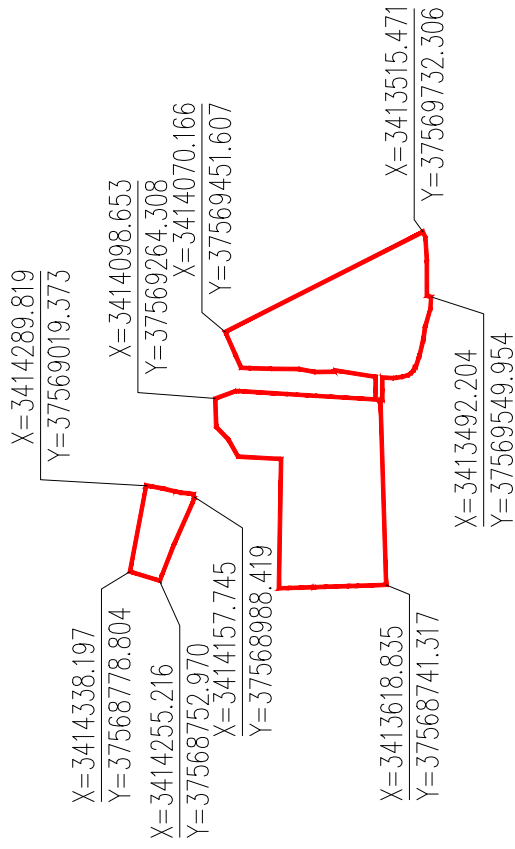
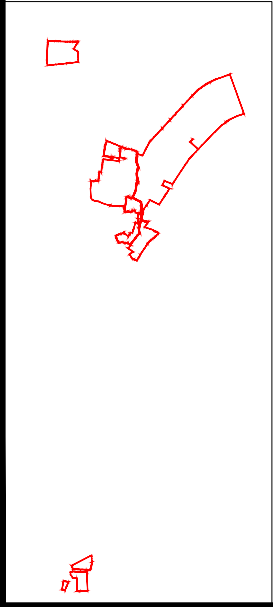

总面积: 11732.84亩

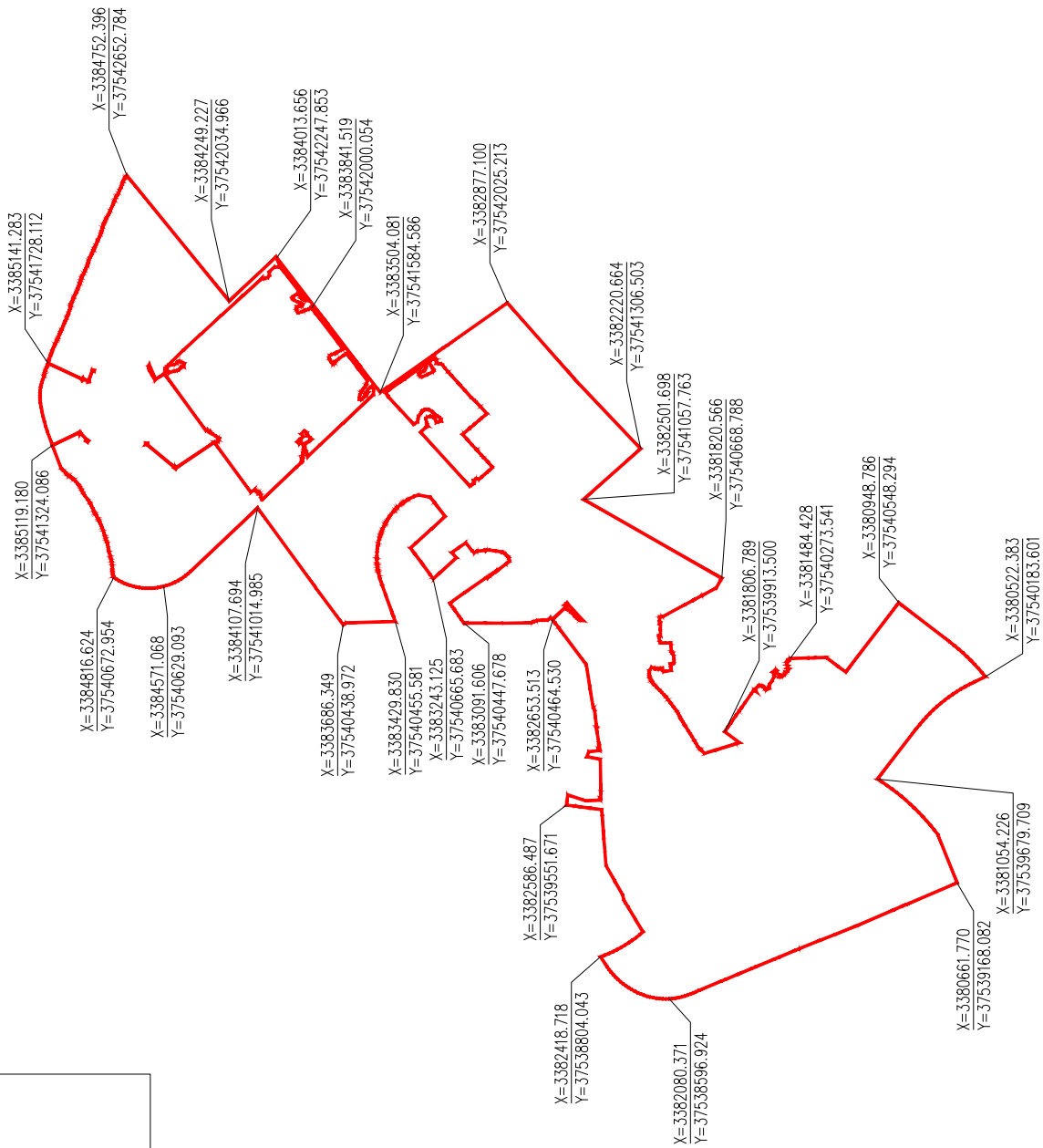
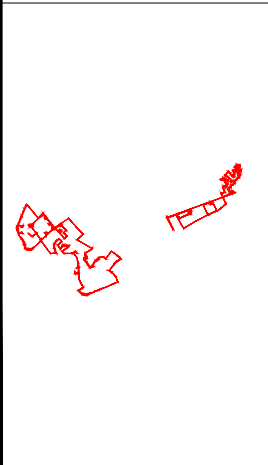

总面积: 10035.51亩

名称: 獭亭化工园	指北针		图例	范围线	坐标标注
-----------	-----	--	----	-----	------

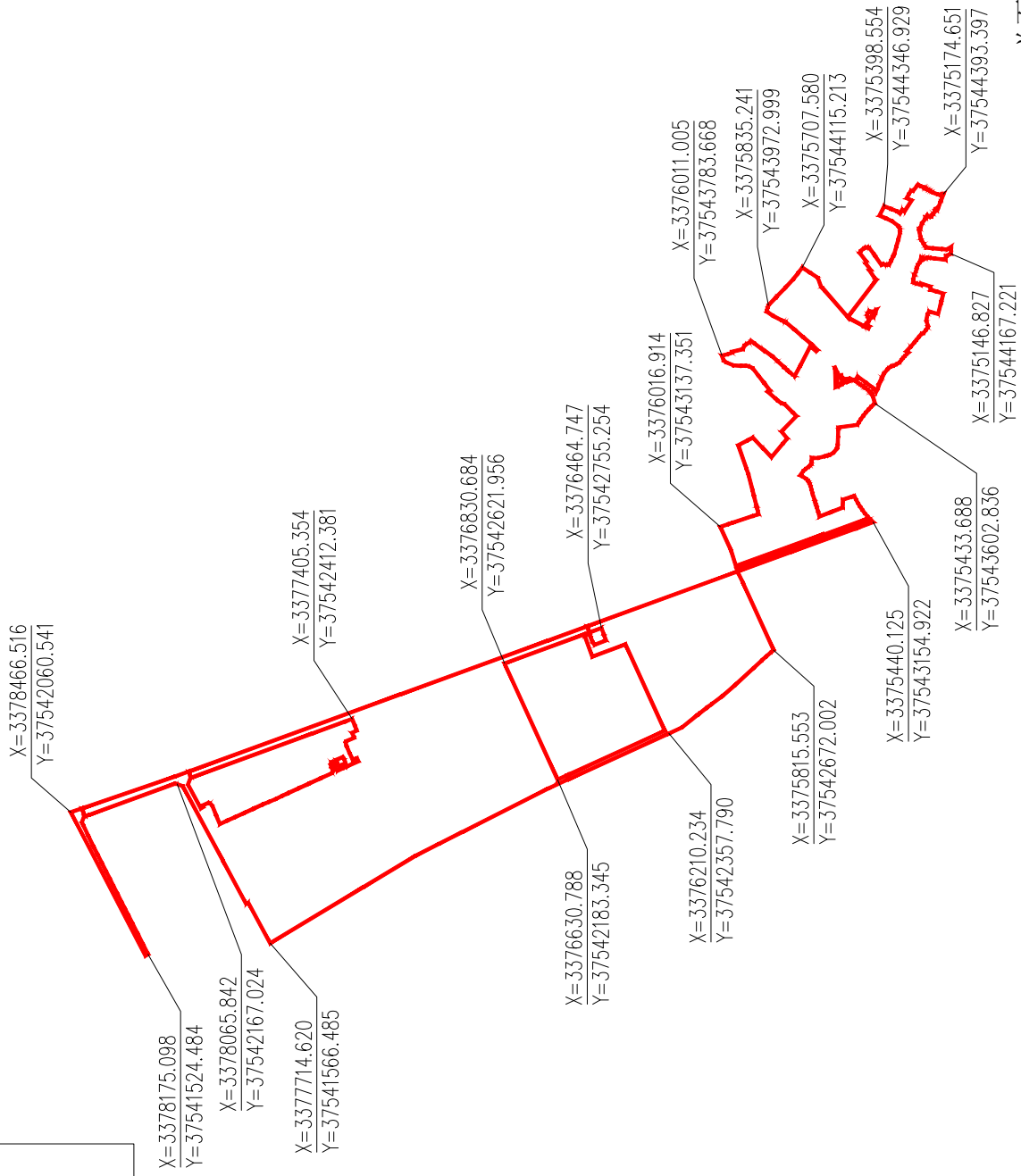
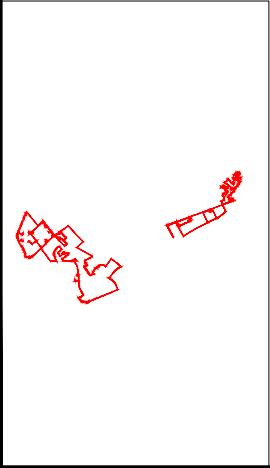

总面积: 10035.51亩

名称: 獭亭化工园

指北针



图例



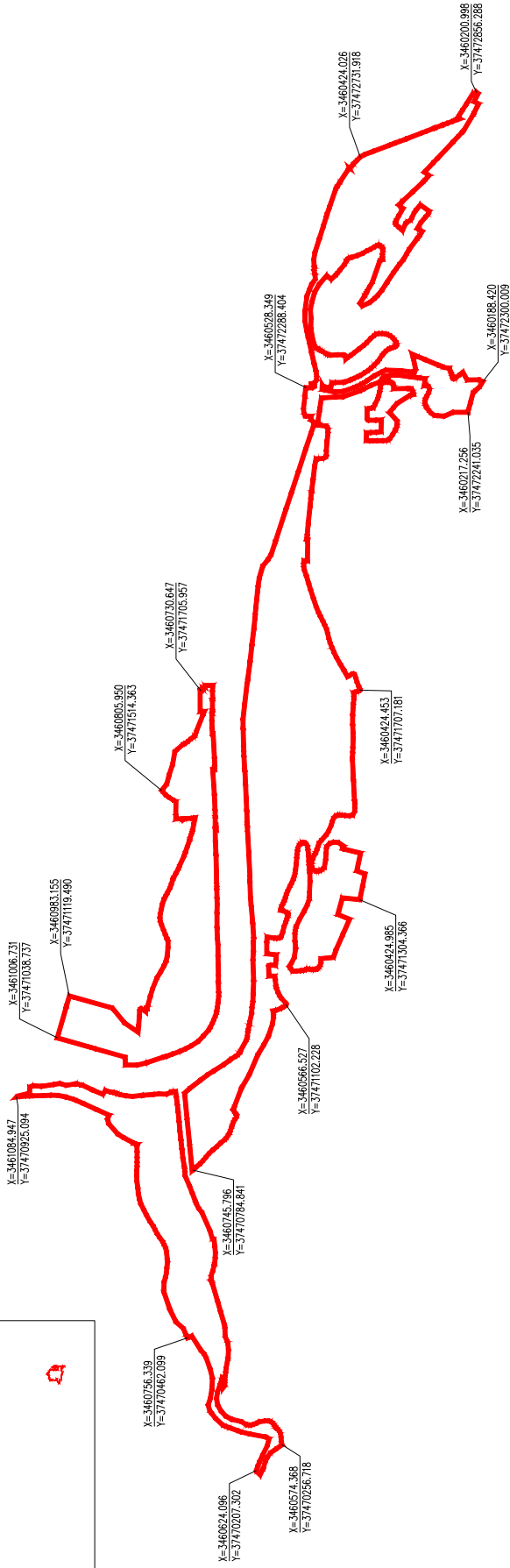
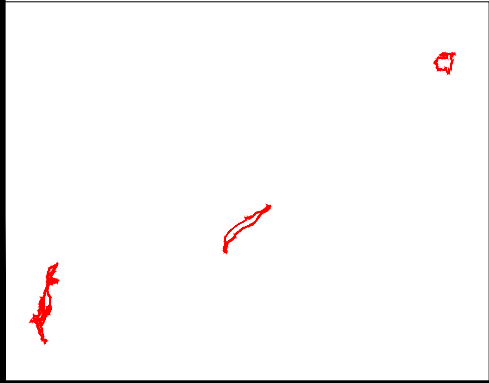

总面积: 1422.83亩

名称: 兴山化工园

指北针



图例

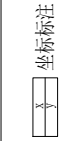
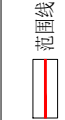

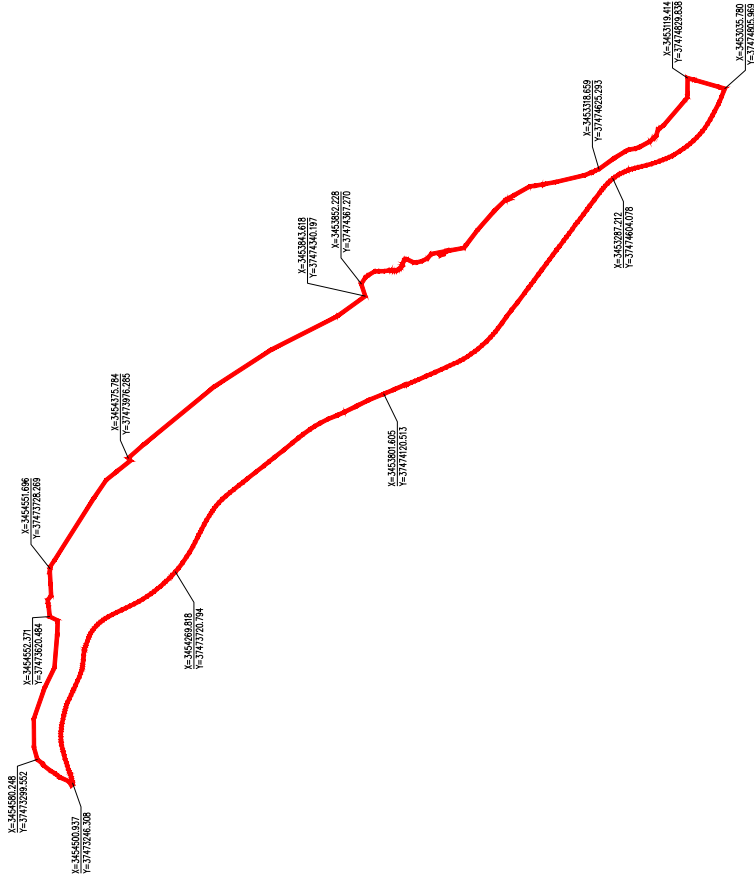
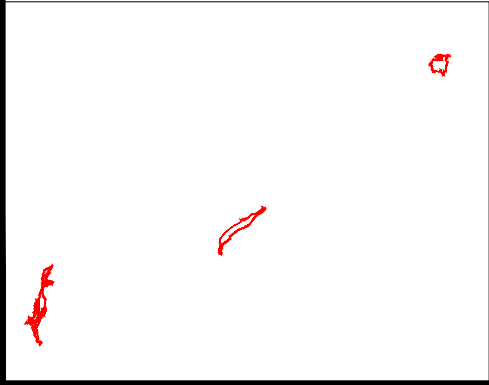

总面积: 1422.83亩

名称: 兴山化工园

指北针



图例

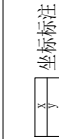
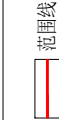

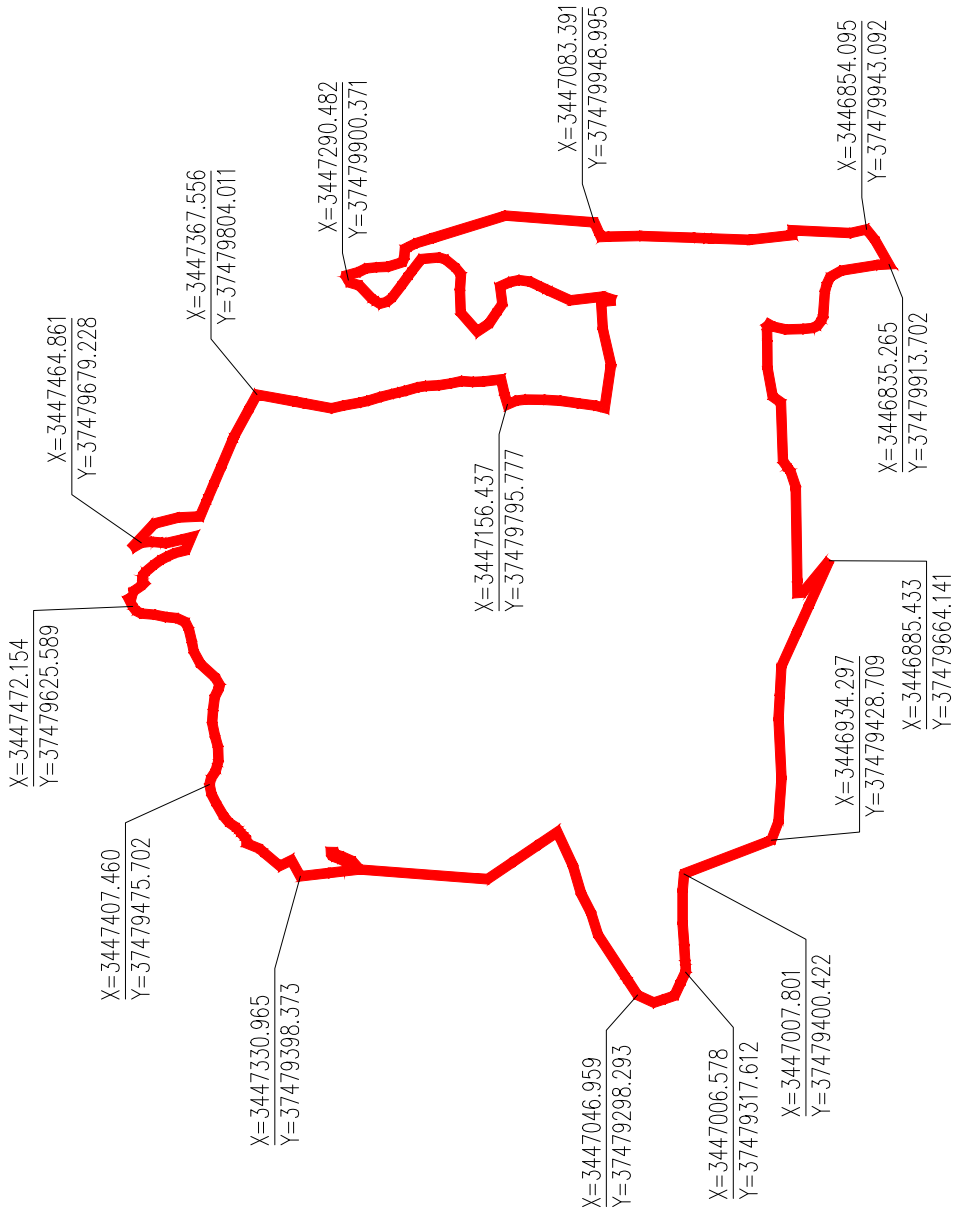
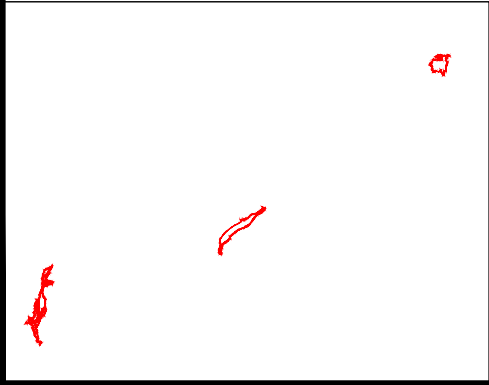

总面积: 1422.83亩

名称: 兴山化工园

指北针



图例

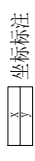
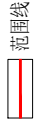

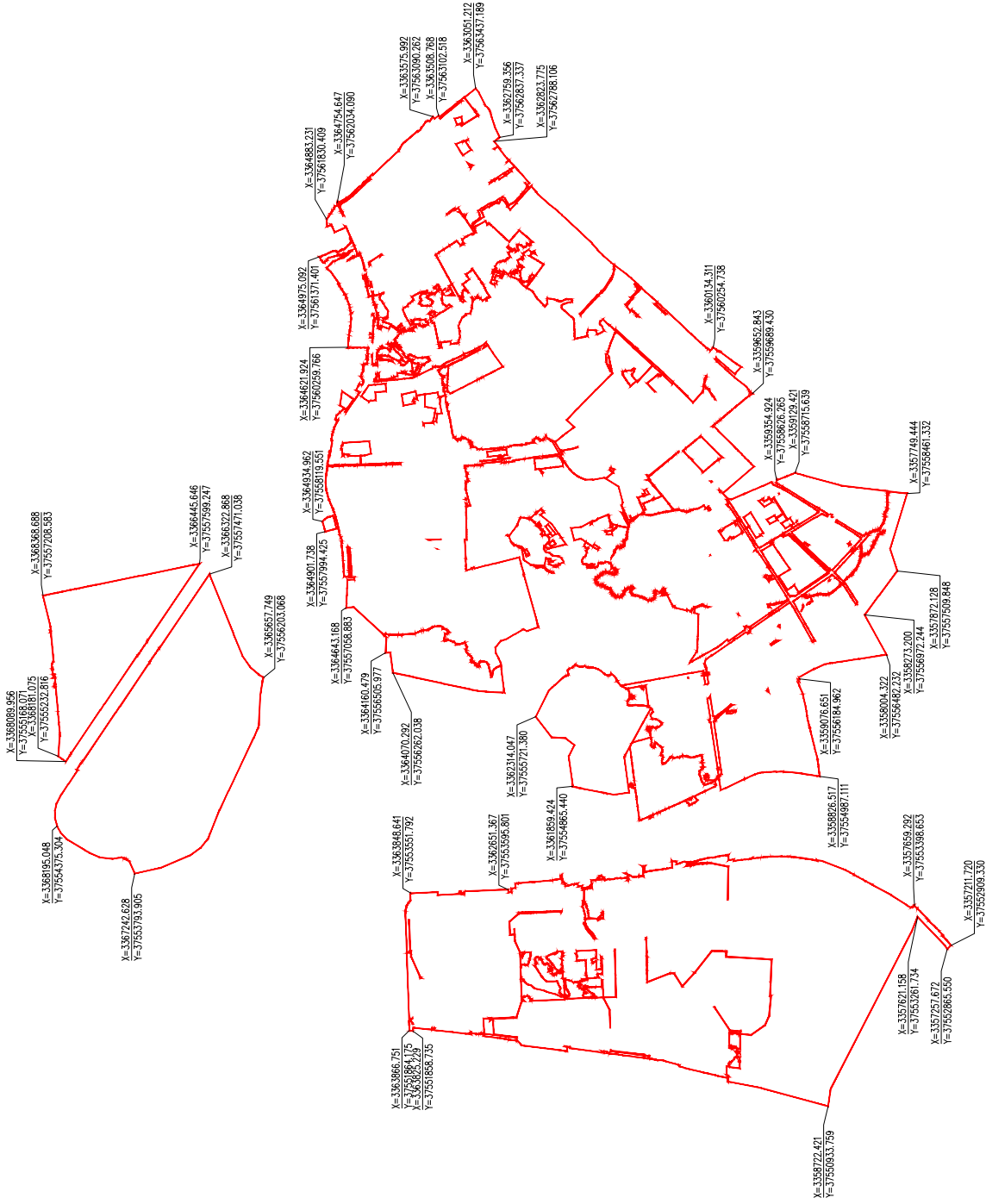

总面积: 69573.15亩

名称: 宜昌姚家港化工园

指北针



图例

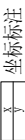

坐标注

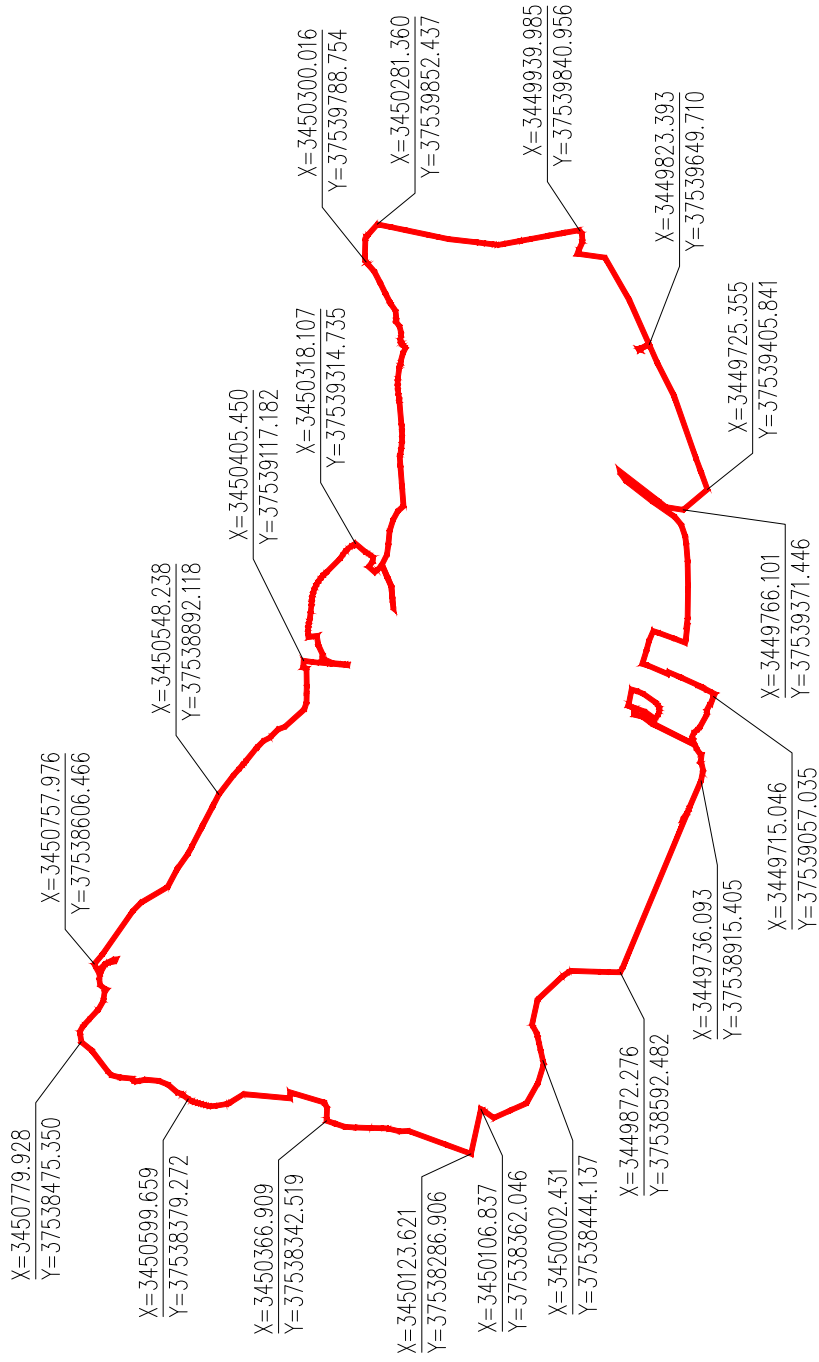
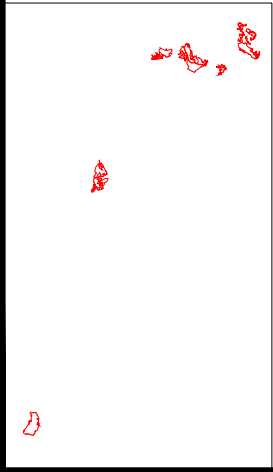

总面积: 6794.07亩

名称: 远安化工园	指北针		图例	范围线	坐标标注
-----------	-----	--	----	-----	------

100

100

X=3446175.644

Y=37554834.337

X=3446162.779

Y=37554681.355

X=3446126.002

Y=37554782.551

X=3446054.112

Y=37554753.698

X=3445909.841

Y=37554913.109

X=3445770.390

Y=37554846.493

X=3445619.885

Y=37554835.518

X=3445516.457

Y=37554871.966

X=3445416.734

Y=37554928.058

X=3445316.995

Y=37555200.003

X=3445218.604

Y=37555348.162

X=3445074.728

Y=37555589.745

X=3445147.840

Y=375555863.316

X=3446073.123

Y=37555381.874

X=3446031.719

Y=37555568.830

X=3446010.049

Y=37555761.622

X=3445947.375

Y=37556196.071

X=3445647.496

Y=37556679.031

X=3445672.369

Y=37556844.353

X=3445461.264

Y=37556569.025

X=3445372.871

Y=37556388.442

X=3445235.892

Y=37556092.664

X=3445159.454

Y=37556039.512

总面积: 6794.07亩

名称: 远安化工园

指北针



图例



范围线

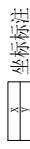

坐标标注

100

100

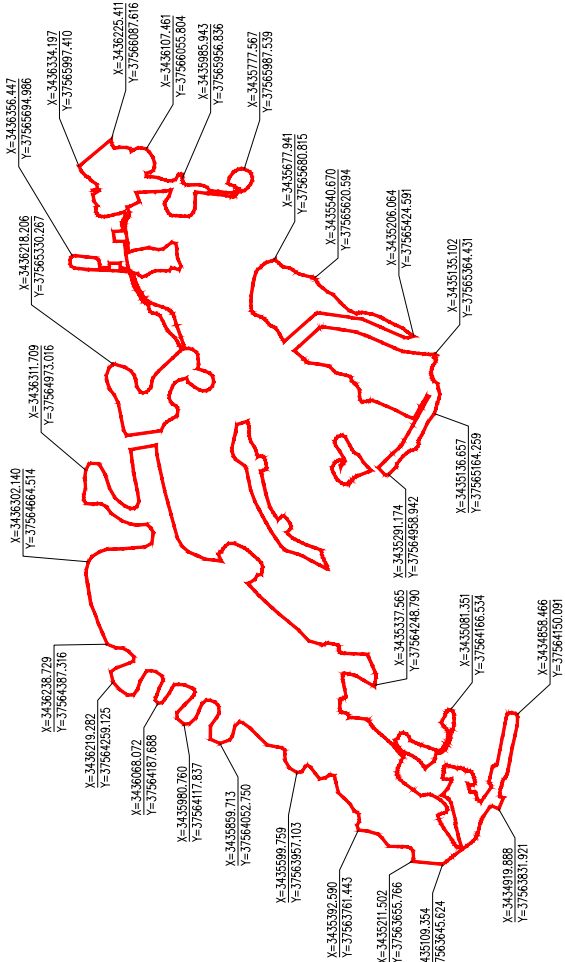
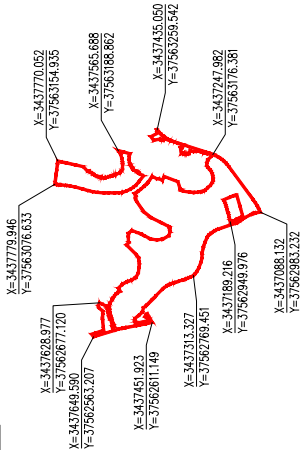

总面积: 6794.07亩

名称: 远安化工园

指北针



图例



坐标标注



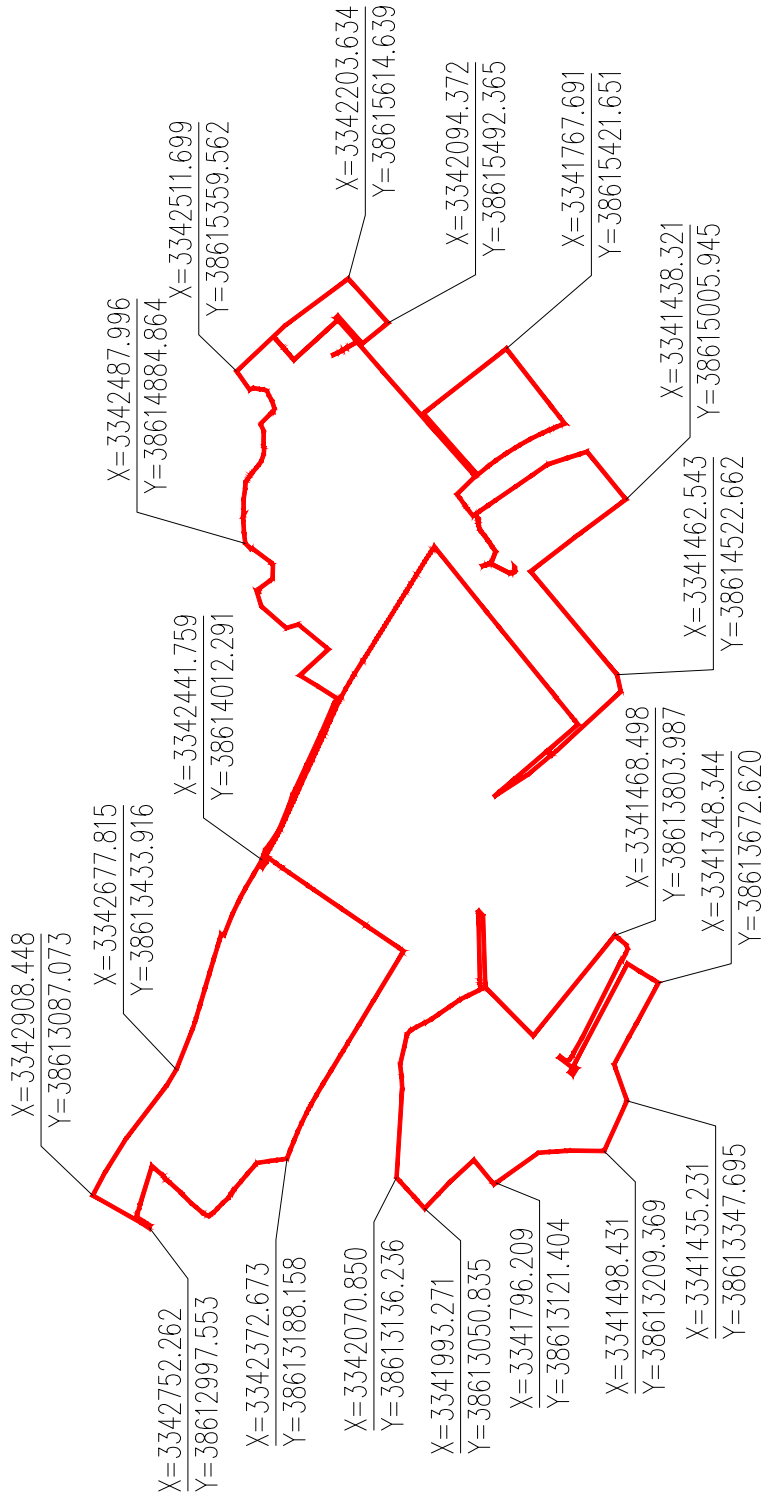

总面积: 1997.79亩

名称: 西塞山工业园区化工园

指北针



图例

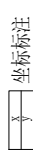

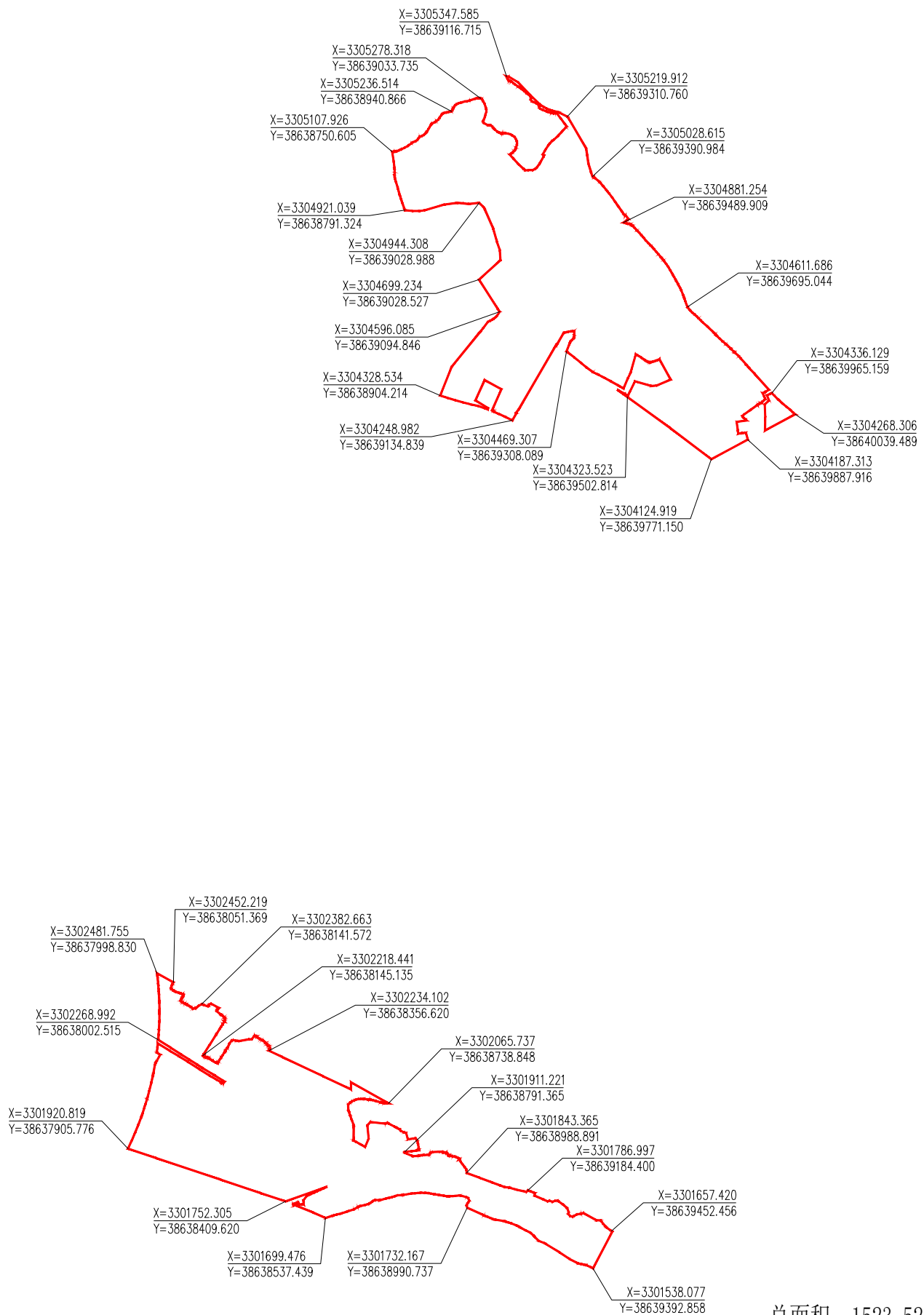

总面积：1523.52亩

名称：阳新经济开发区滨江工业园（医药化工园区）

指北针



图例

 范围线

X
Y

 坐标标注

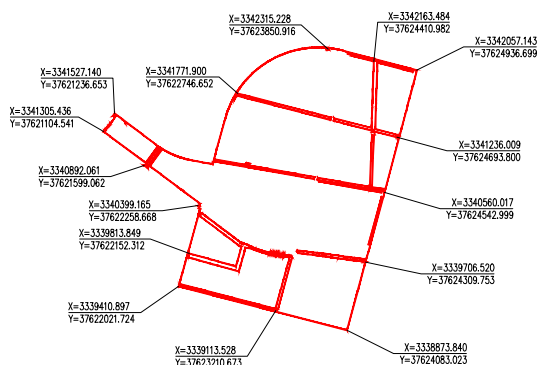
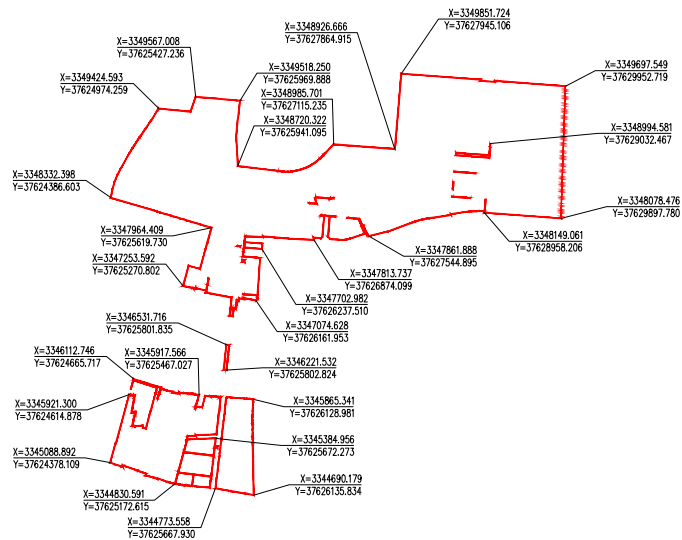
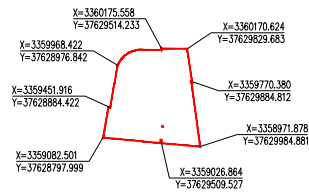

总面积：25694.52亩

名称：荆州经济技术开发区化工园区（含沙市化工园）

指北针



图例

范围线

坐标标注

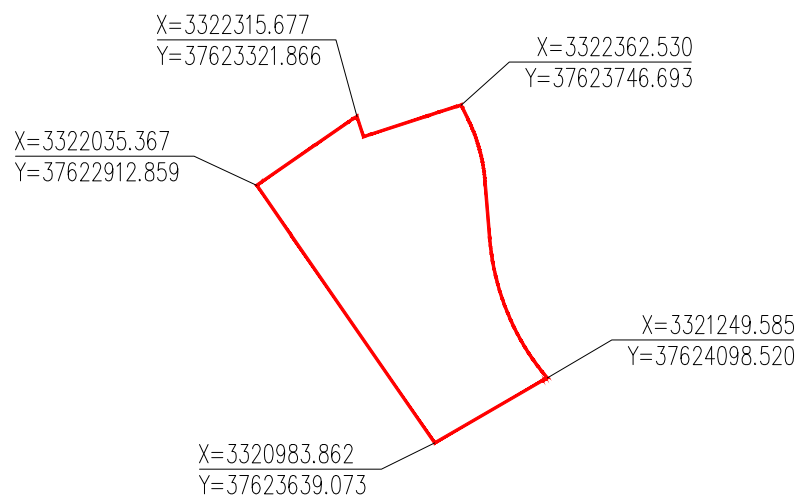
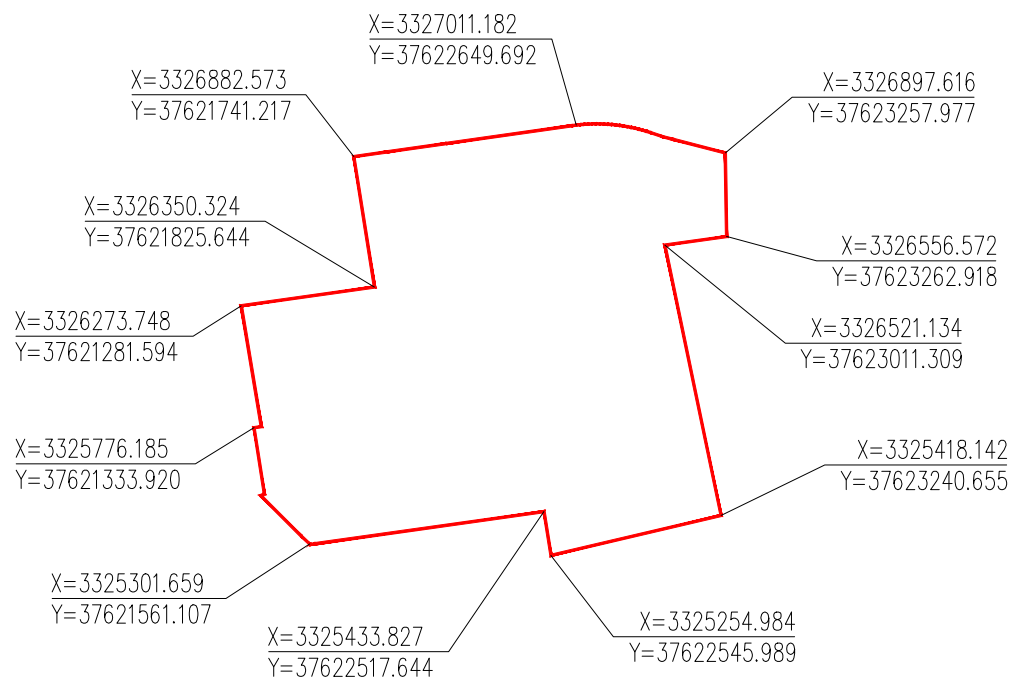

总面积: 5231.48亩

名称: 公安县化工园区

指北针



图例

范围线

坐标标注

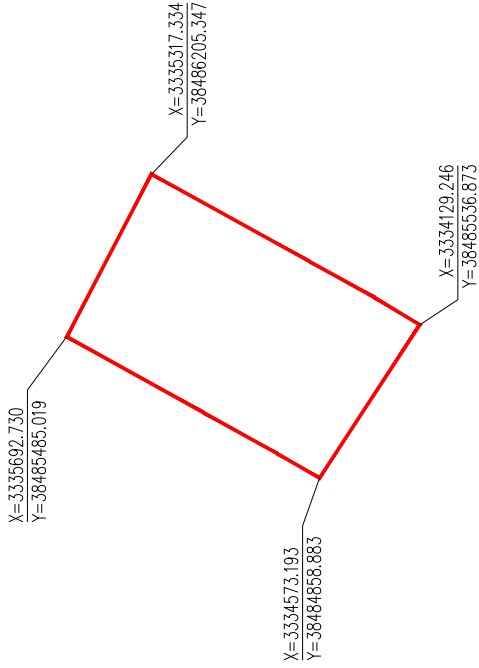
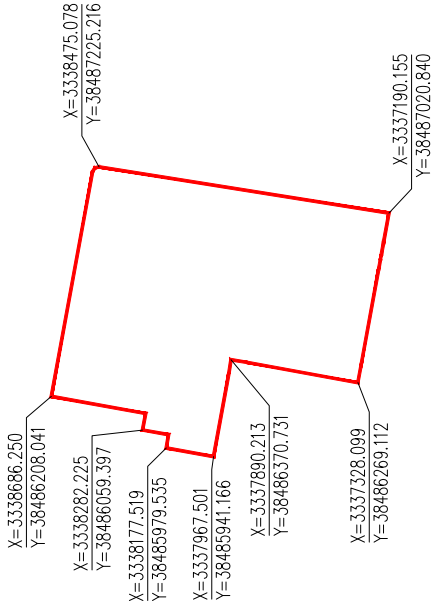

总面积: 3501.62亩

名称: 武汉经济技术开发区洪湖新滩经济合作区化工园区

指北针



图例

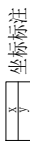

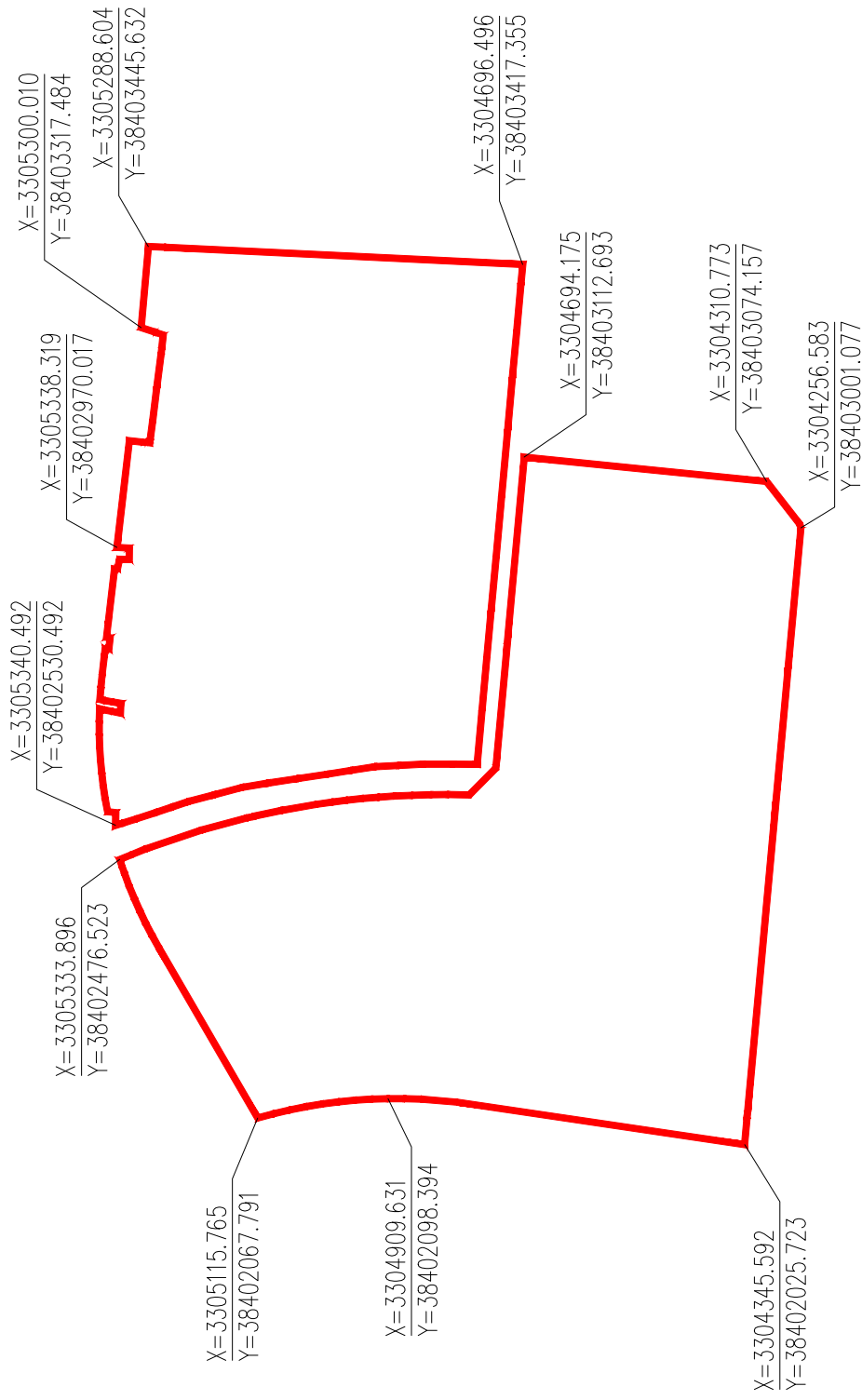

总面积: 1769.13亩

名称: 监利市医药化工园区

指北针



图例



范围线



坐标标注

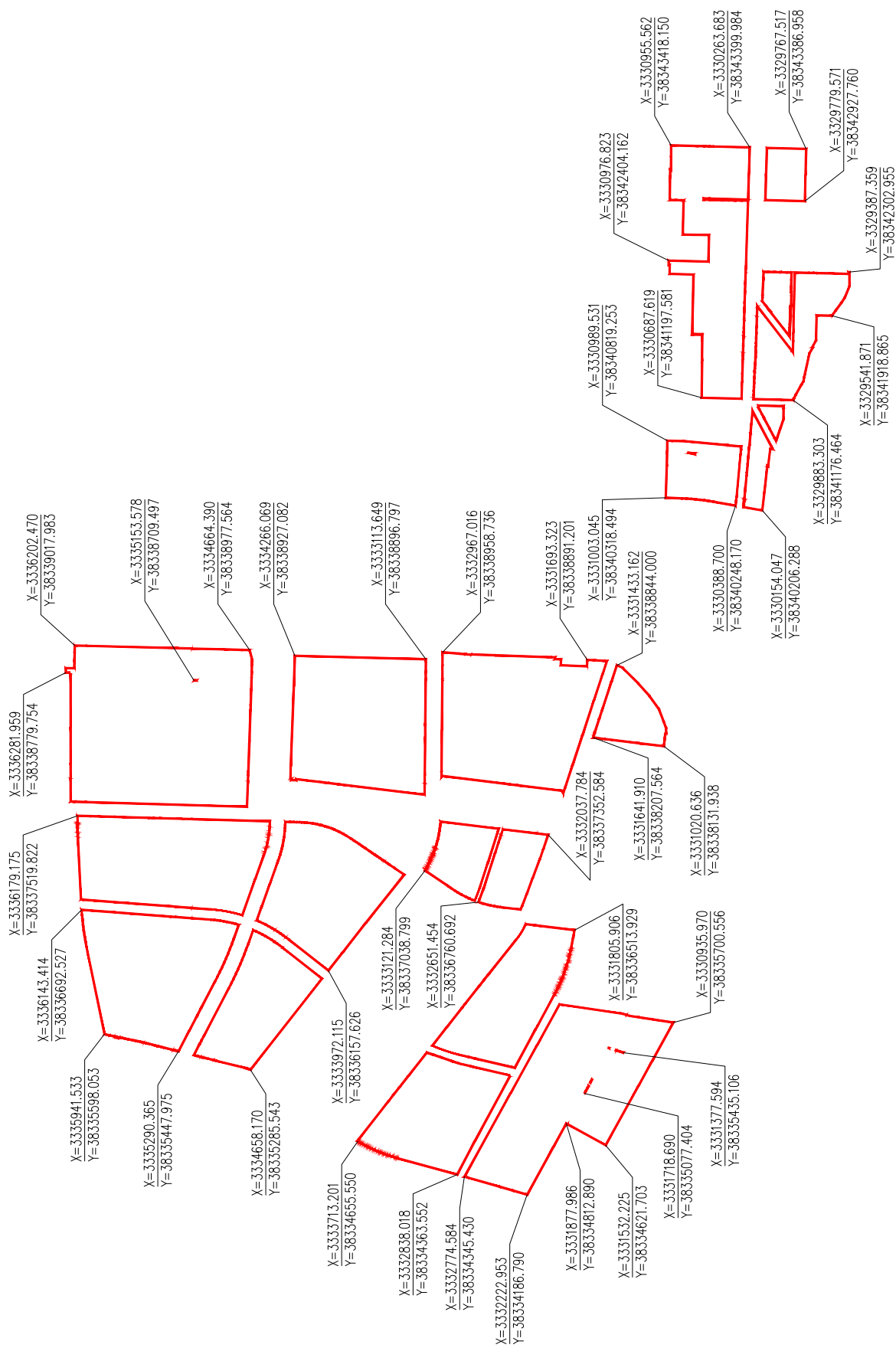

总面积: 22707.12亩

名称：江陵县化工园区



指南针



图例

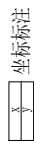

坐标标注

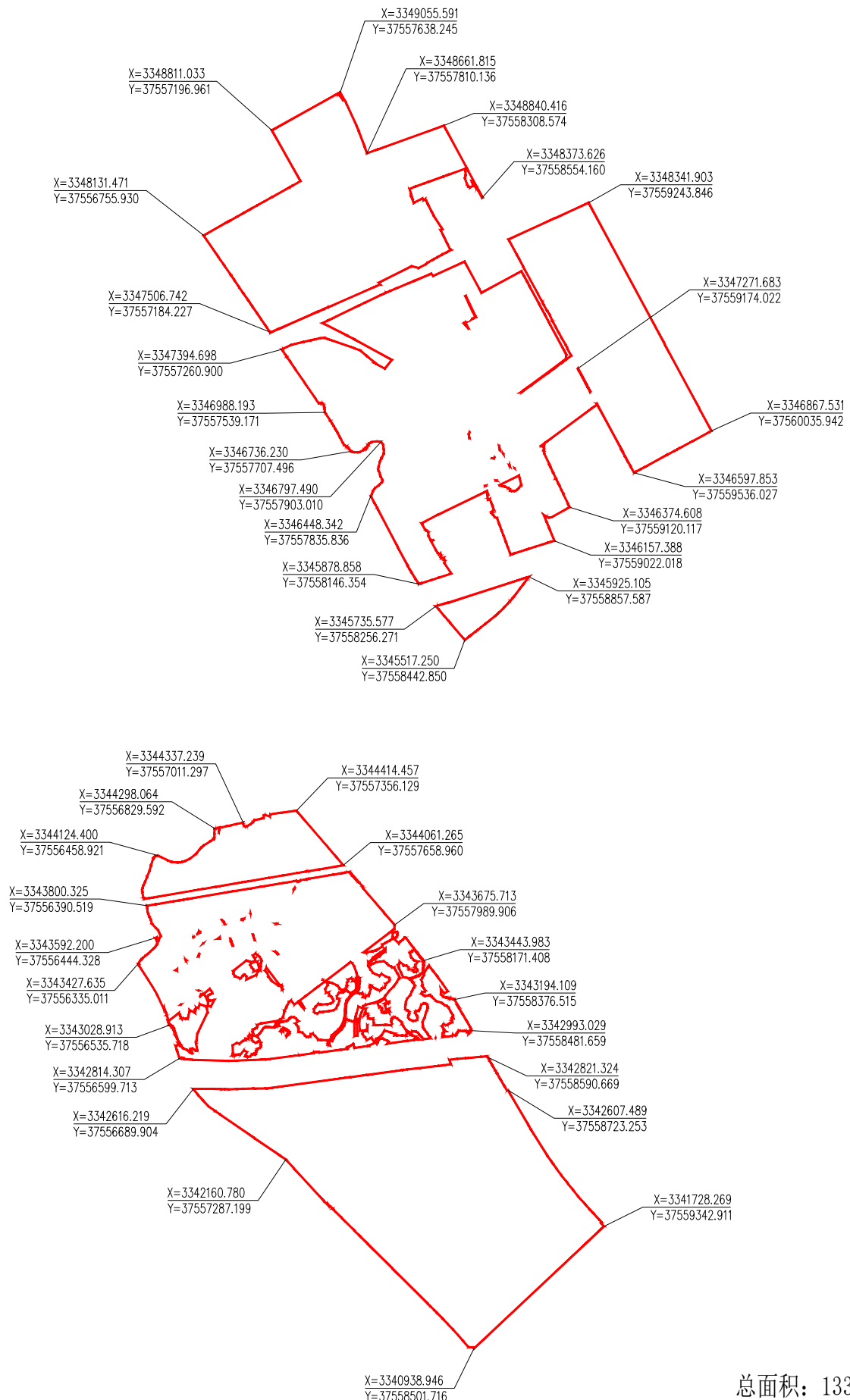

名称: 松滋市化工园区

指北针



图例

范围线

坐标标注

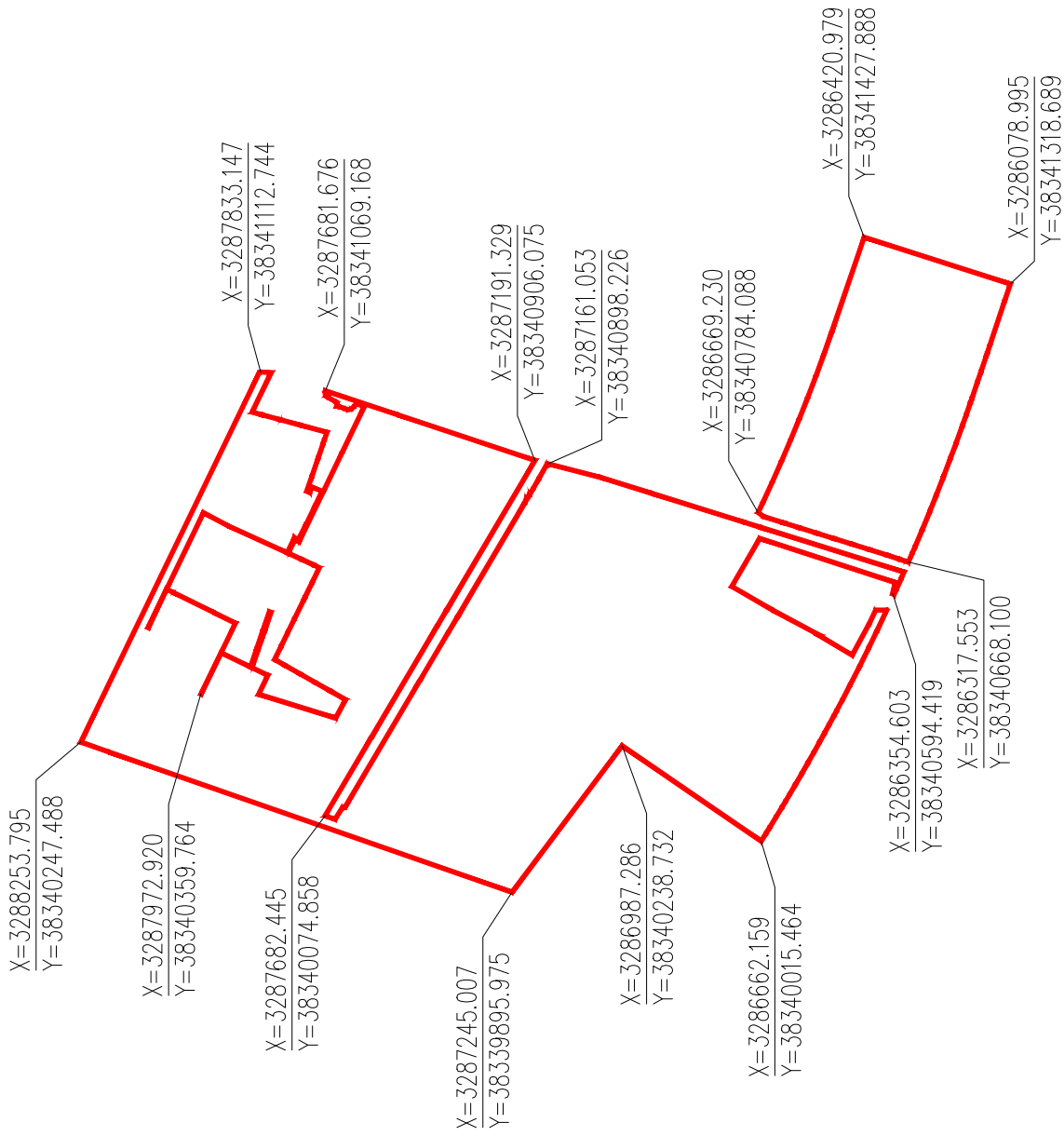

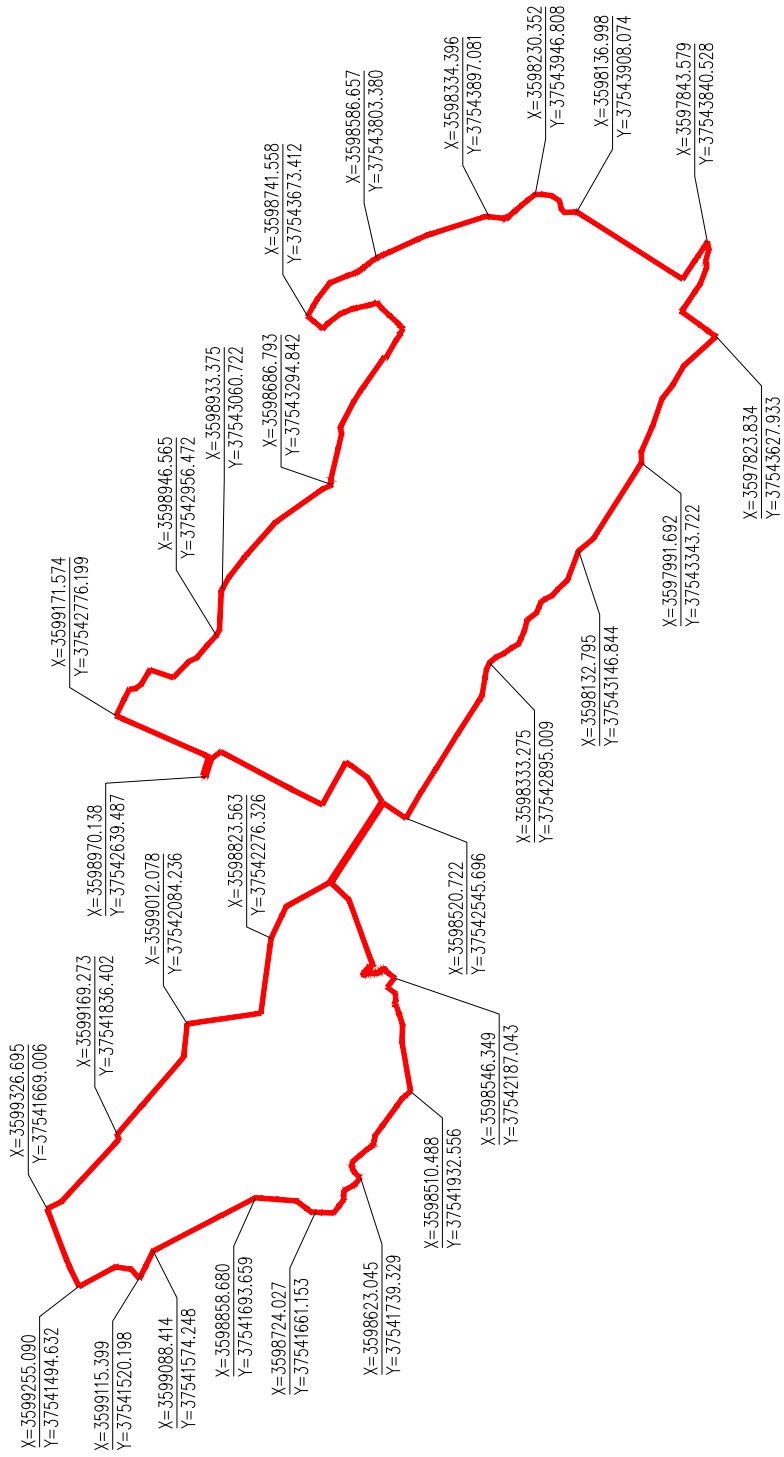

总面积: 2584.92亩

名称: 丹江口市生命健康产业园

指北针



图例

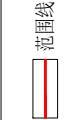

坐标标注

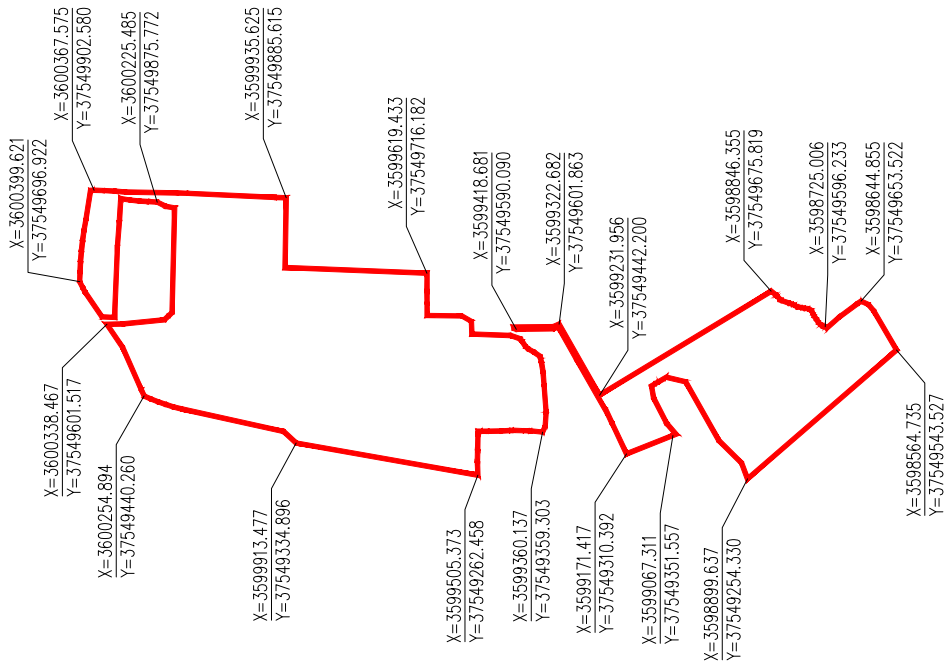

总面积: 2584.92亩

名称: 丹江口市生命健康产业园

指北针



图例



范围线

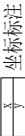

坐标标注

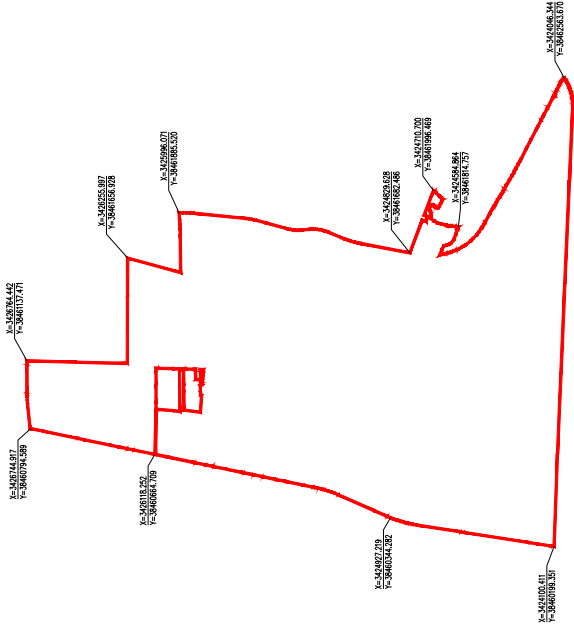
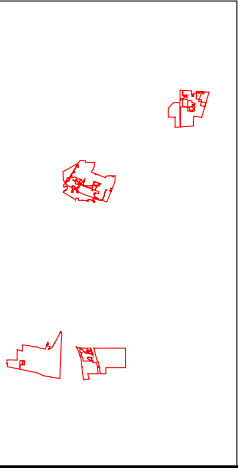

总面积: 15937.11亩

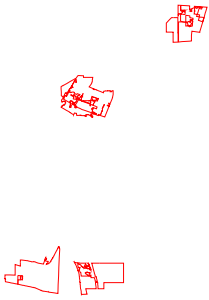

总面积: 15937.11亩

名称: 湖北应城化工产业园区 (东城工业园、赛孚工业园、盐化工业园)



指北针

图例

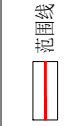

范围线

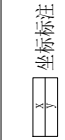

坐标标注

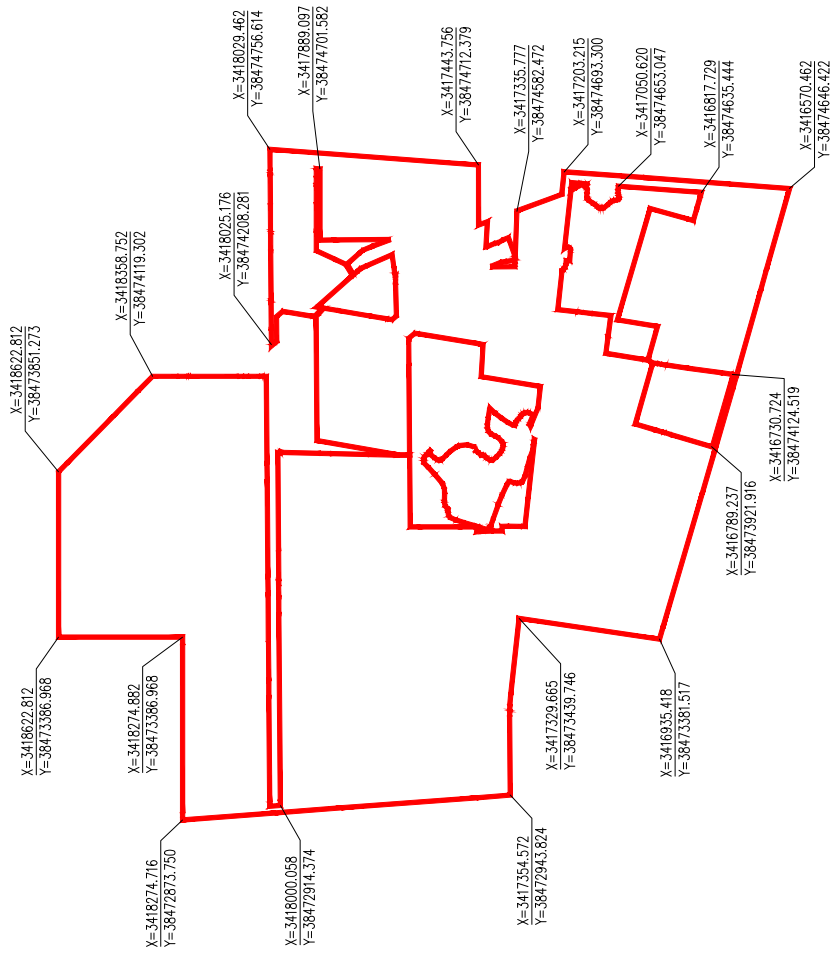
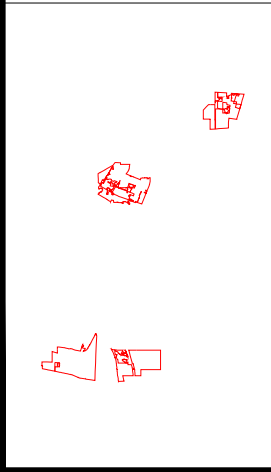

总面积: 15937.11亩

名称: 湖北应城化工产业园区 (东城工业园、赛孚工业园、盐化工业园)



指北针

图例



范围线



坐标标注

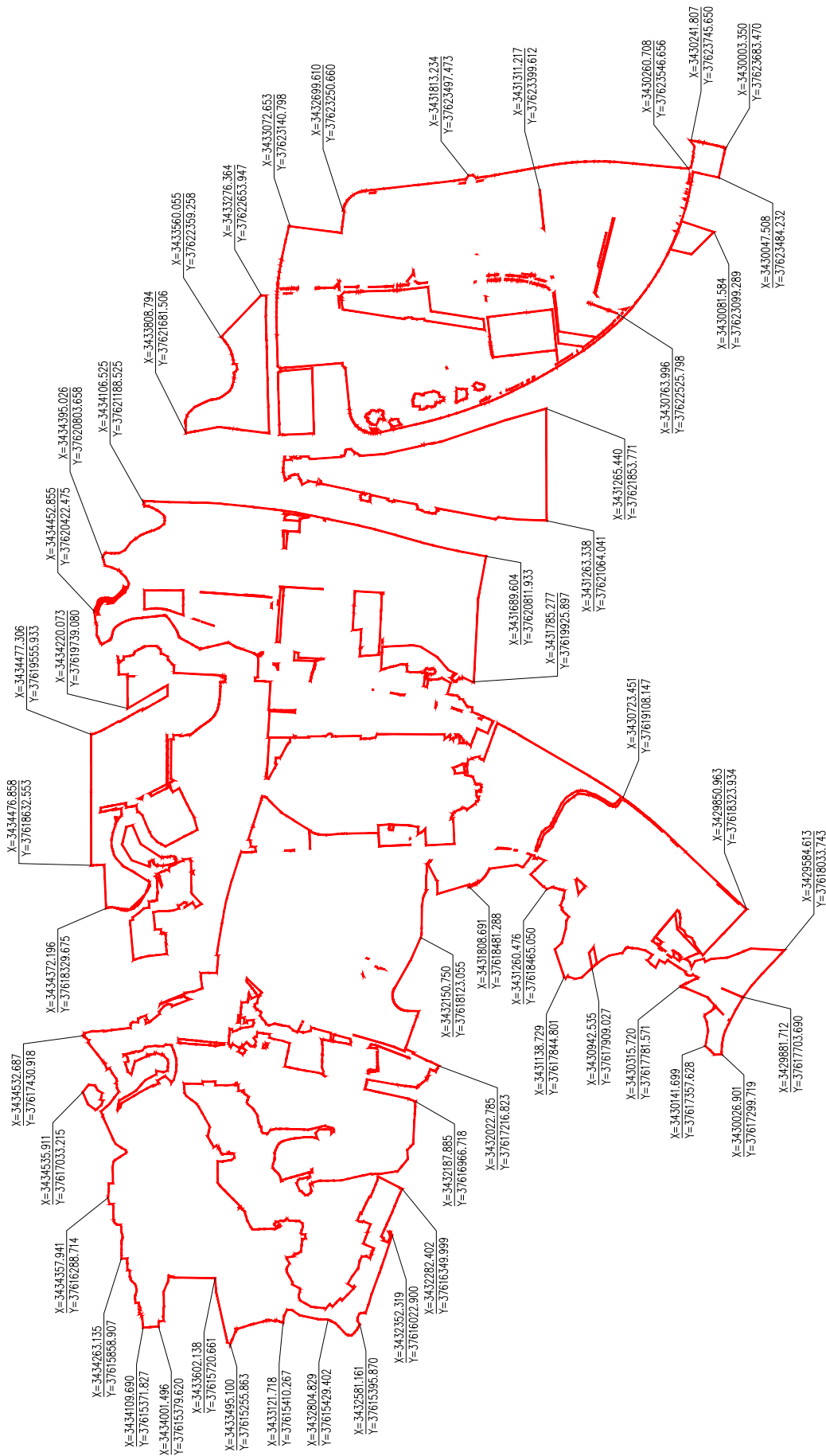

总面积: 23576.42亩

名称: 荆门化工循环产业园

指北针



图例



坐标注

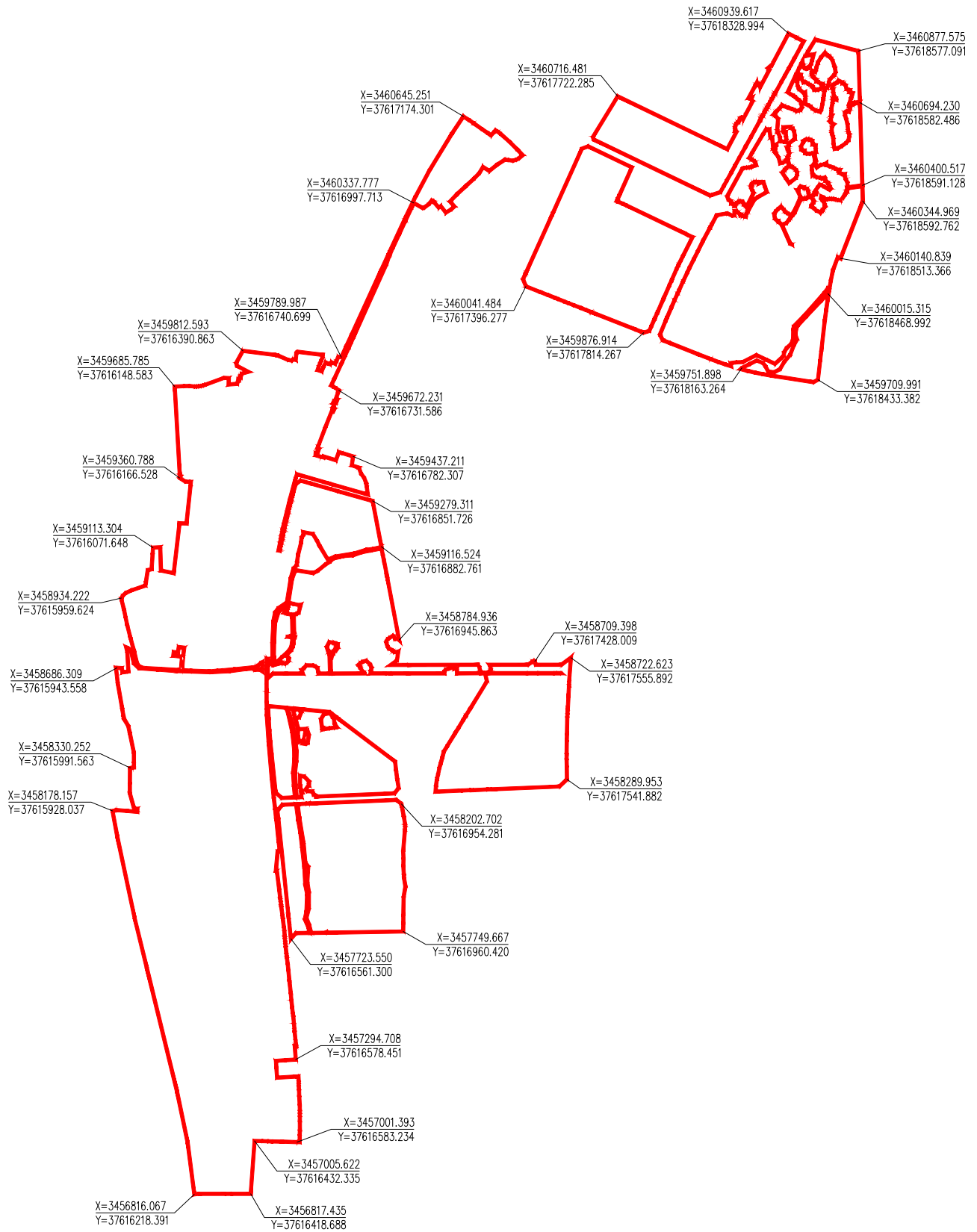

总面积: 4357.40亩

名称: 东宝化工循环产业园

指北针



图例

范围线

坐标标注

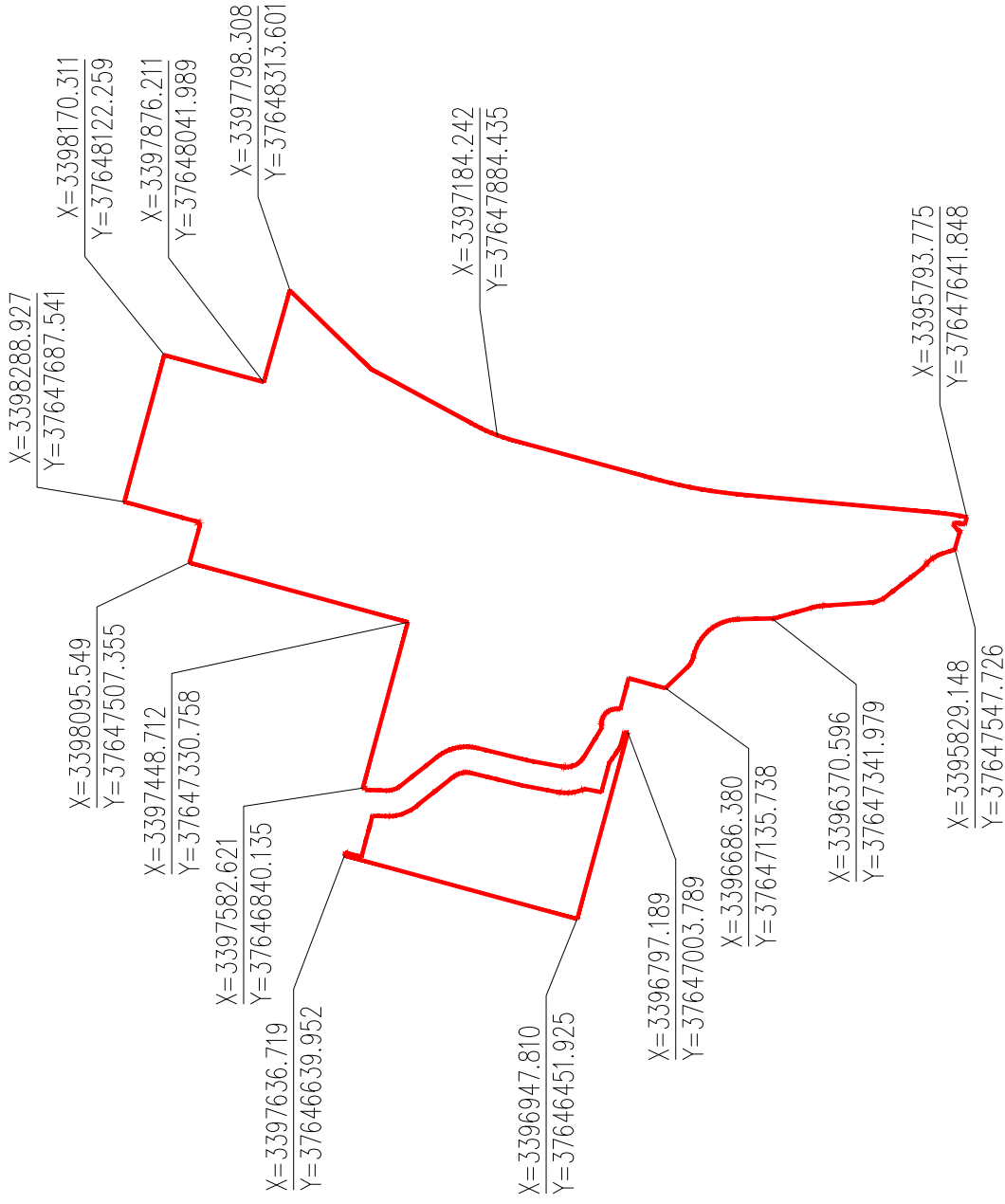

总面积: 2562.63亩

名称: 沙洋县化工集中区

指北针



图例



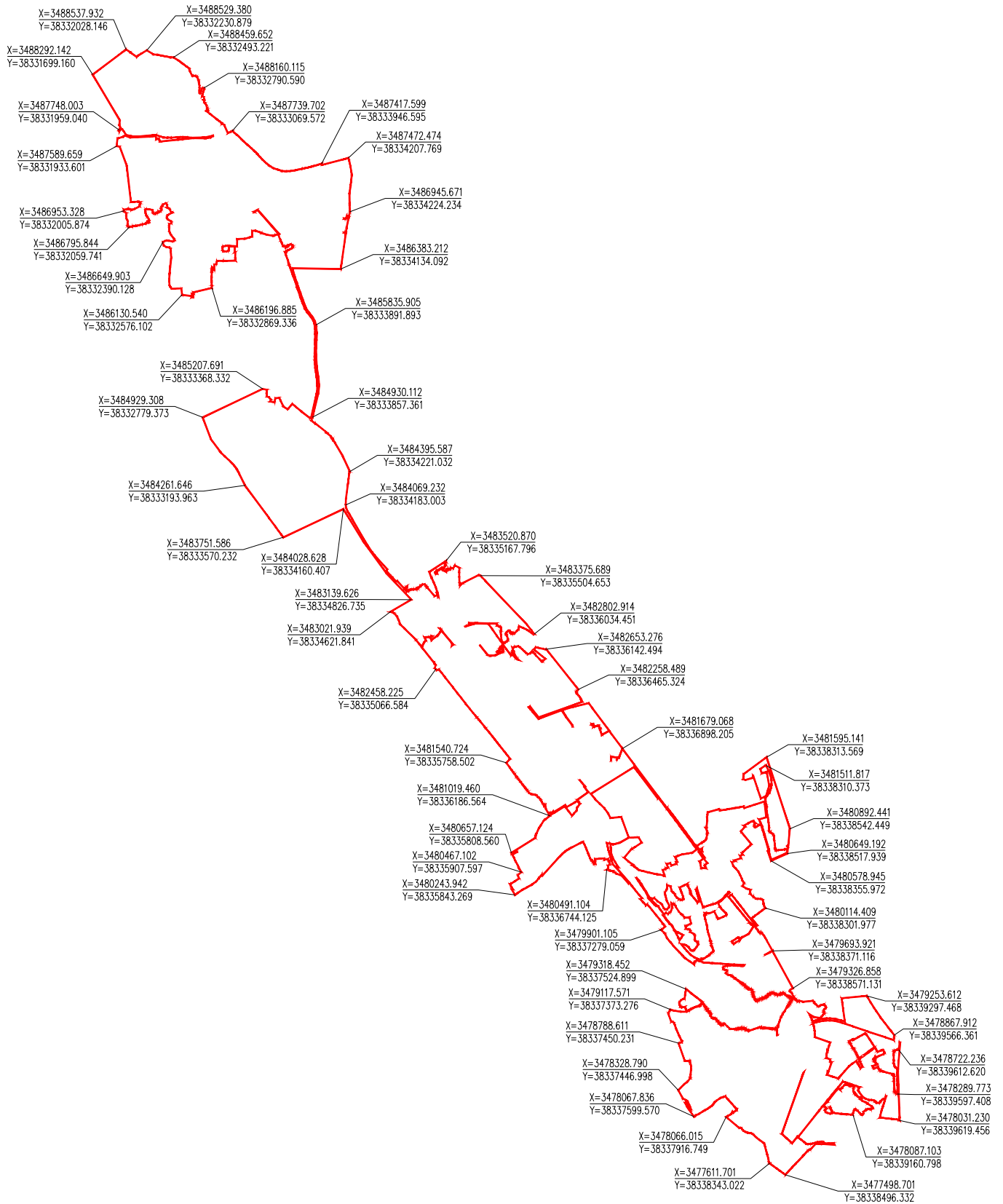

名称: 钟祥胡集经济开发区化工园区

指北针



图例

范围线

坐标标注



总面积: 14296.28亩

名称: 黄冈高新技术产业开发区黄冈化工产业园



指北针

图例



范围线

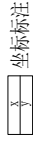

坐标标注

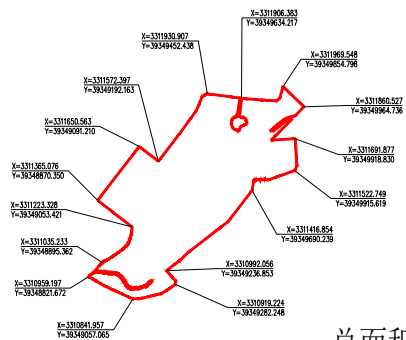
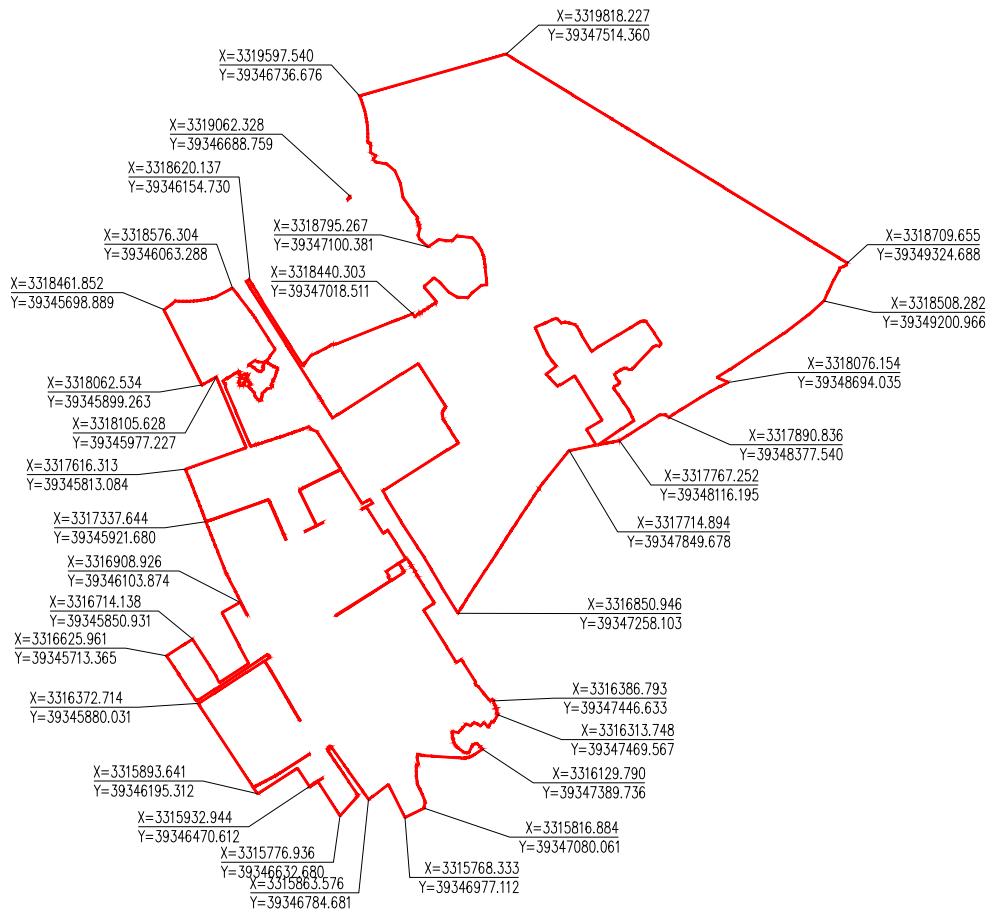

总面积: 9611.71亩

名称: 武穴市田家镇“两型”社会建设循环经济试验区马口化工产业园

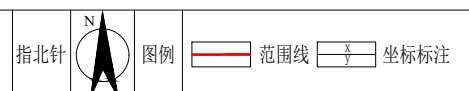

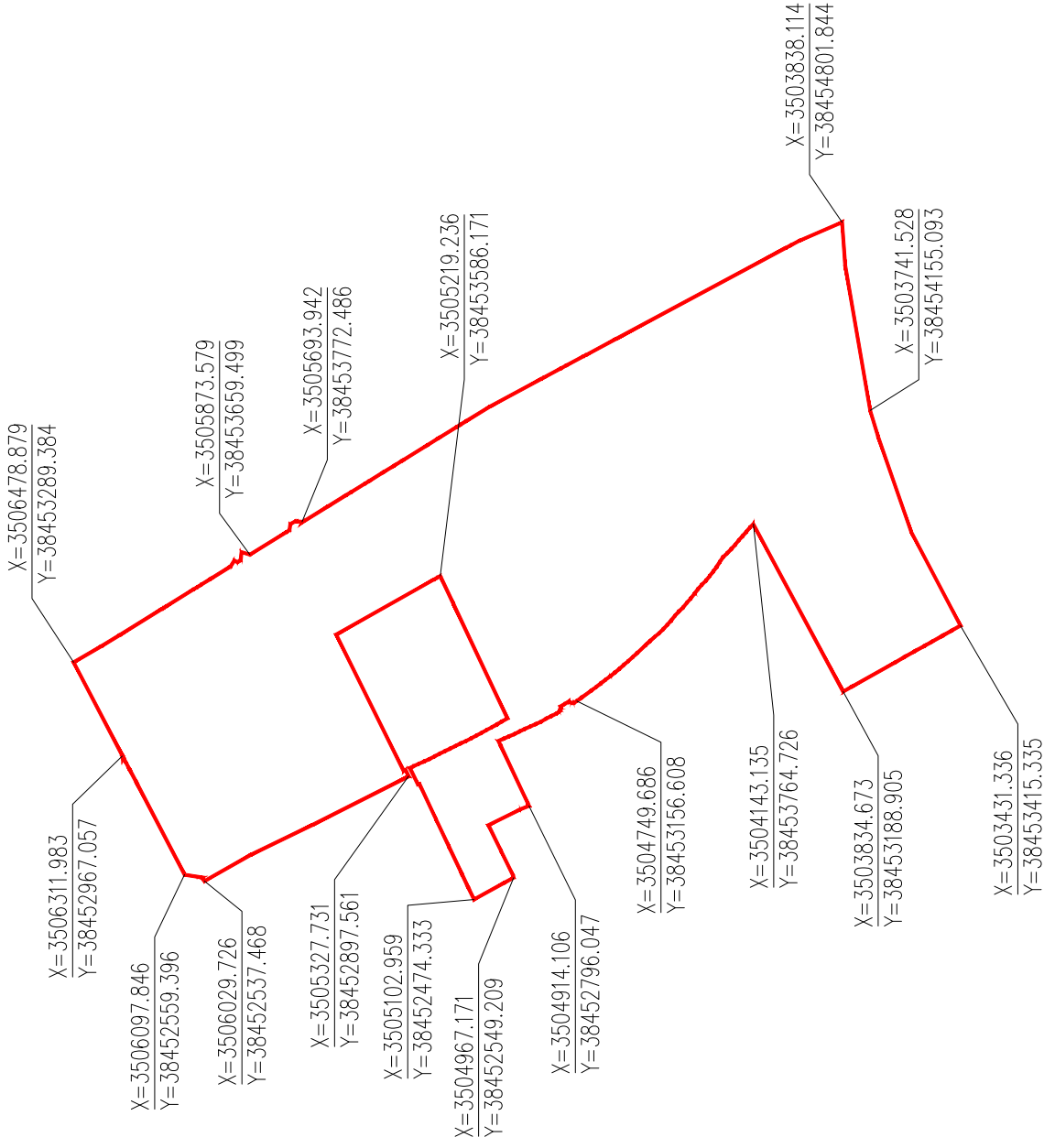

总面积: 4238.57亩

名称: 随州市青春化工工业园

指北针



图例



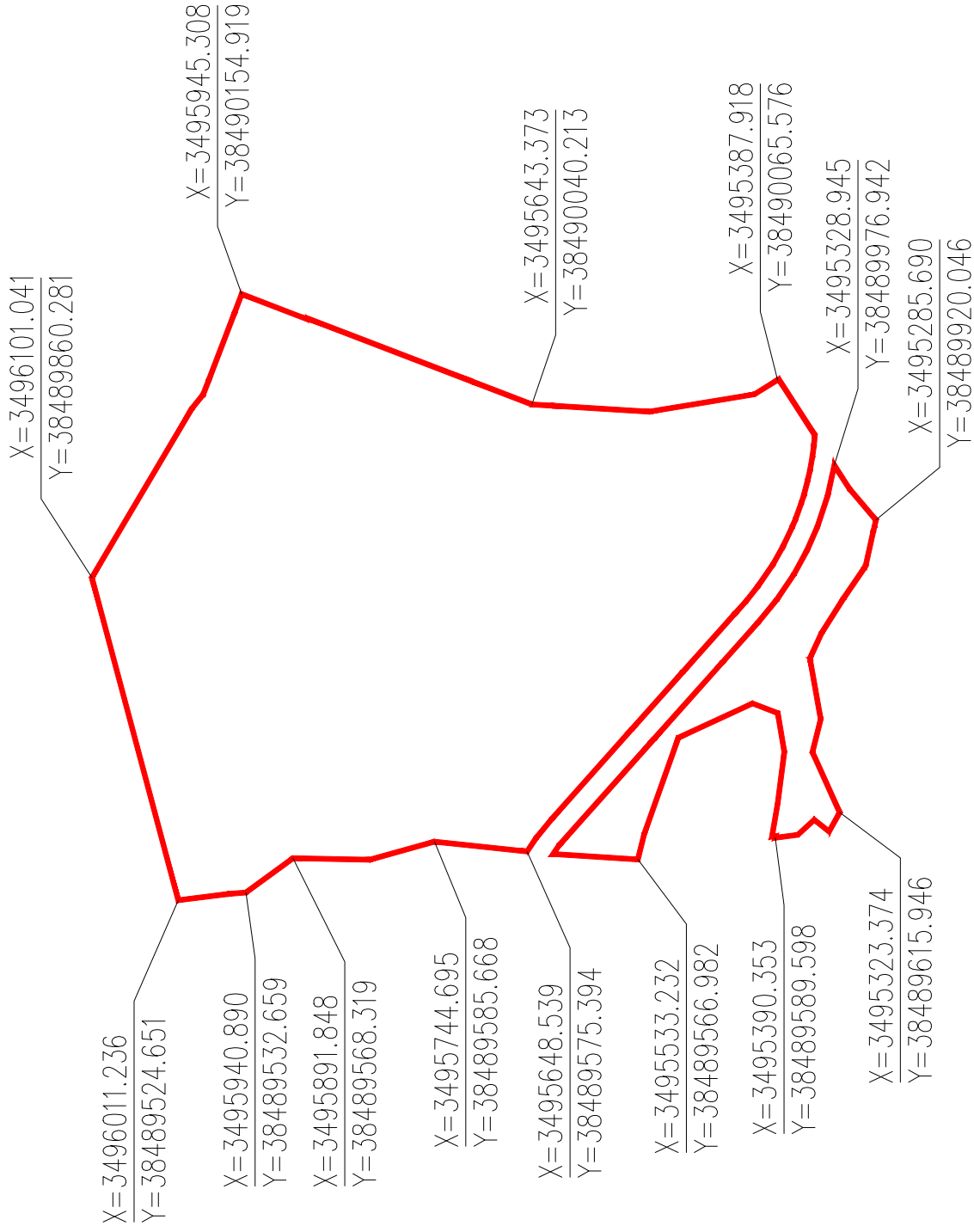

总面积: 499.17亩

名称: 广水市化工园区

指北针



图例



范围线



坐标标注



总面积: 95.87亩

名称: 恩施市白杨坪产业园 (化工区)

指北针



图例

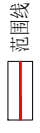

范围线



坐标标注



总面积: 5018.25亩

名称: 嘉鱼县武汉新港潘湾工业园化工园区

指北针



图例

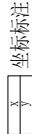

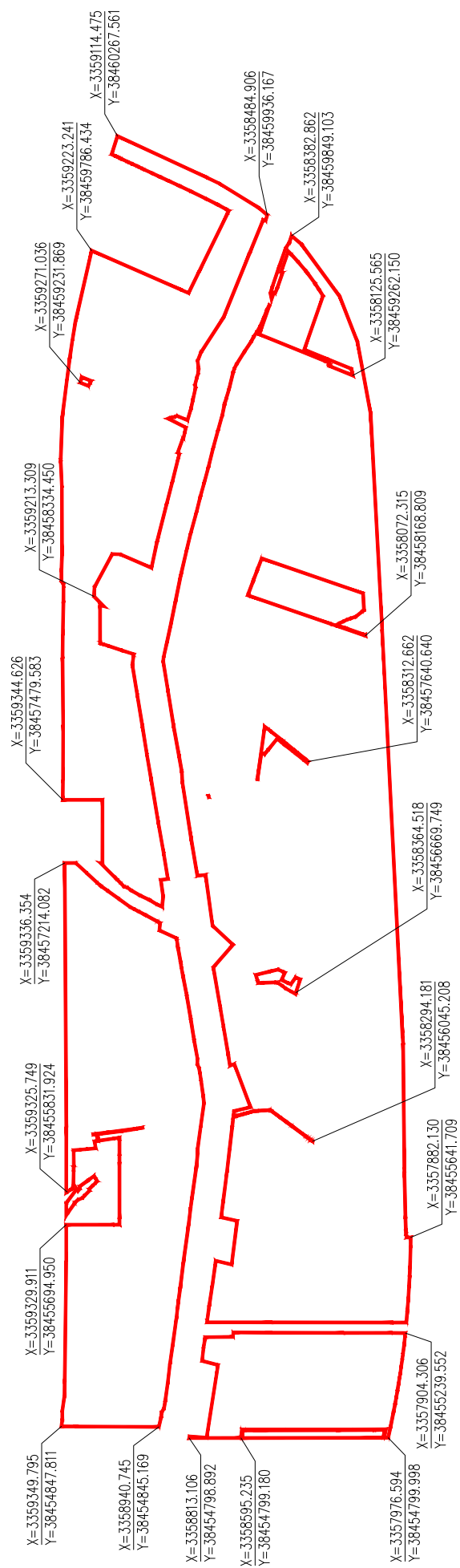

总面积: 9202.13亩

名称: 仙桃市化工园 (新材料产业园区、钛工业园区)	指北针		图例	范围线	坐标标注
----------------------------	-----	--	----	-----	------

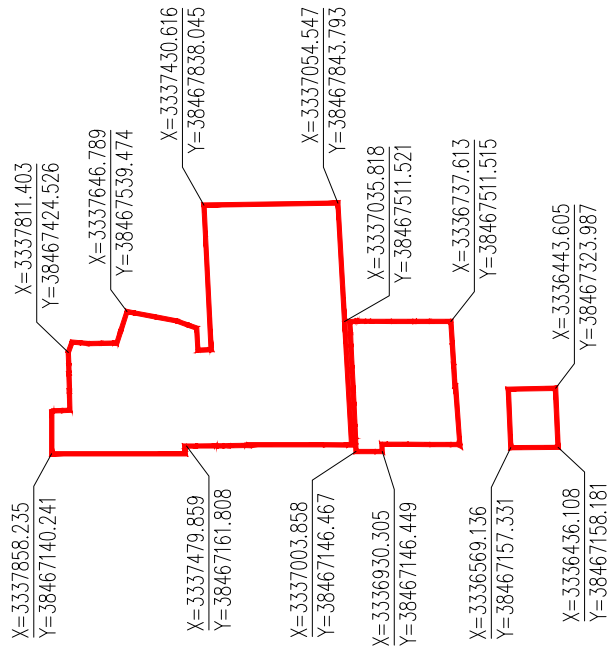

总面积：9202.13亩

名称：仙桃市化工园（新材料产业园区、钛工业园区）

指北针



图例

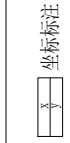
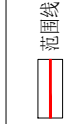

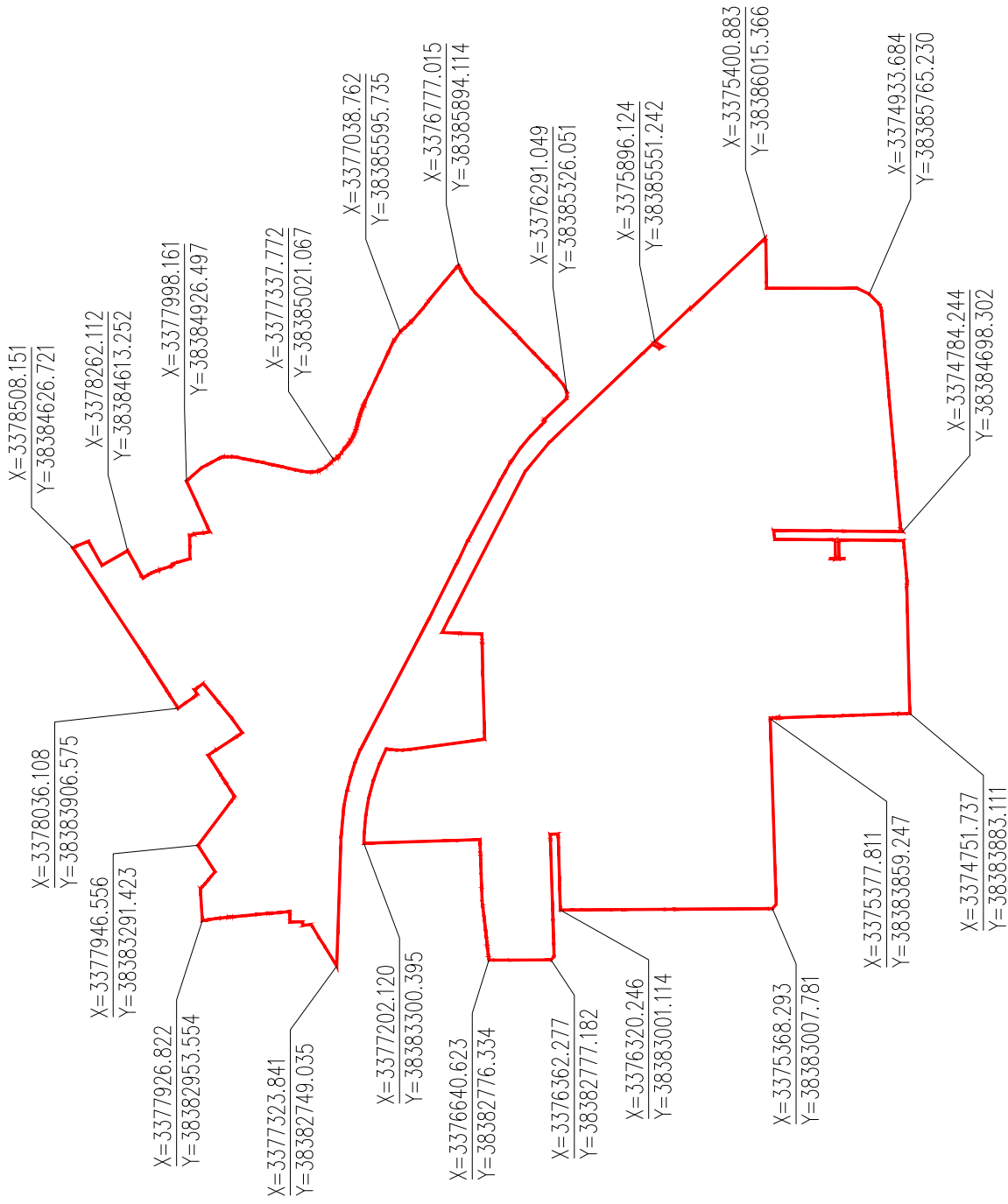

总面积: 10499.09亩

名称: 江汉盐化工业园

指北针



图例



范围线



坐标标注

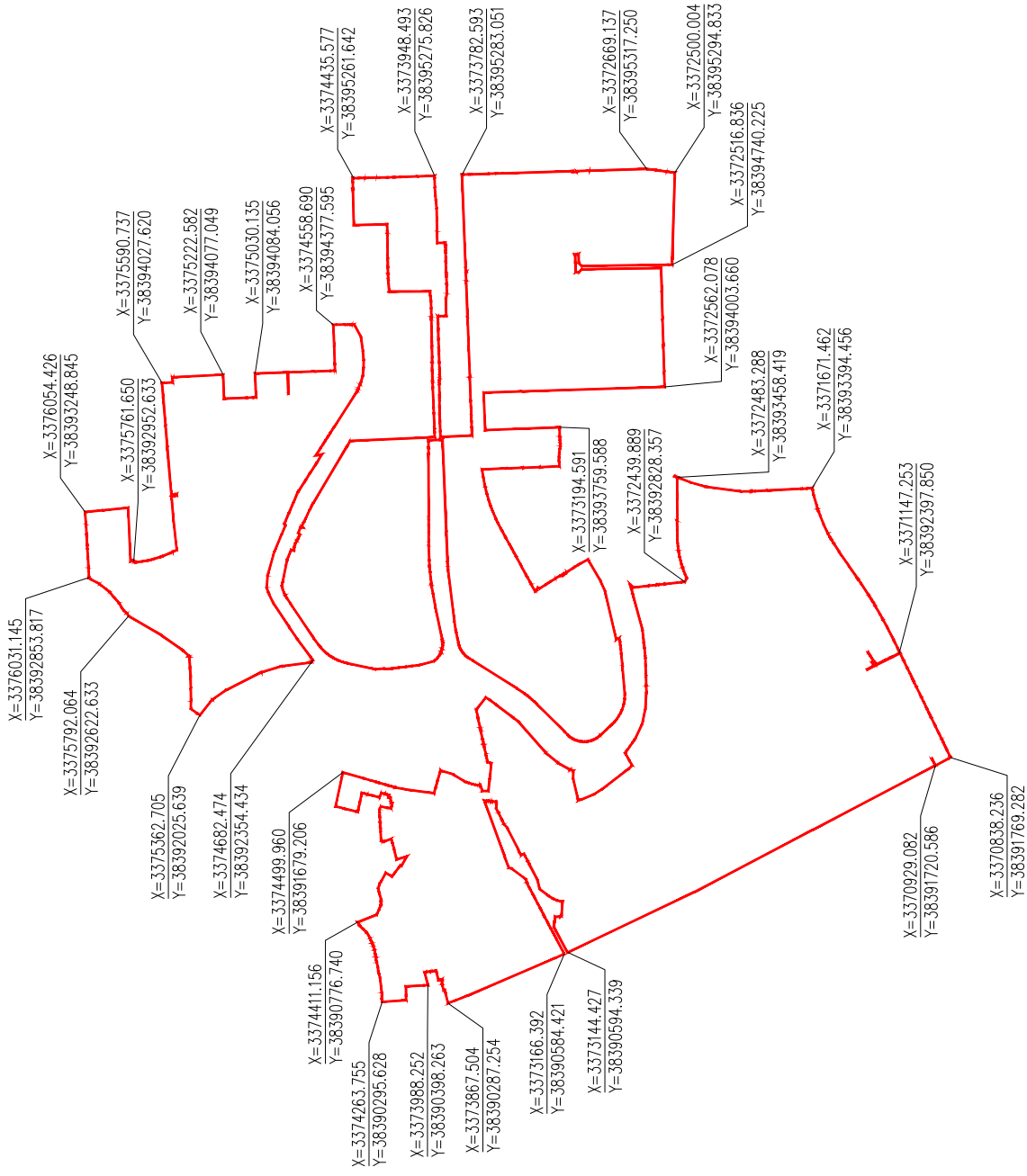

总面积: 16165.87亩

名称: 潜江经济开发区

指北针



图例



范围线

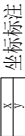

坐标标注



总面积: 5911.44亩

名称: 岳口工业园

指北针



图例



范围线



坐标标注